

DIGITUS Mobile Conference Speaker, Bluetooth and USB compatible

DA-12221

EAN 4016032475132



Bluetooth Conference Speaker 40 mm x4, 10W / DC 5V 1A, 3.5 mm AUX

The DIGITUS® Conference Room Speaker System is designed for stationary and mobile applications. Transform the room of your choice into a conference room. The four integrated speakers ensure an optimal distribution in the room to guarantee clear voice quality for all participants. The speaker can either be connected wirelessly with a smartphone or notebook via Bluetooth or directly via a USB cable connection. The system is compatible with all conventional communication platforms (UC), the main functions can also be controlled directly on the device using the multi-function buttons. The functions include: On/off, accept call, hang up, reject, mute, fast forward, rewind, adjust volume and more. Using the TWS function, two conference speakers can optionally be combined with stereo speakers. With a battery life of up to 10 hours, you can also handle longer calls or conferences.

Conference speaker with TWS function and USB Bluetooth receiver - ideal for mobile use

- Function buttons: 5
- Functions: On/off, play, pause, raise/lower volume, answer/hang up/reject/redial

- Mute/unmute, TWS connection (True Wireless Stereo)
- Integrated speaker/ microphone: 4 pcs.
- Power: 10 W
- Diameter: 40 mm
- Charging voltage: 5 V DC / 1 A
- Bluetooth version: 5.0
- USB connection: Micro USB
- Aux in: 3.5 mm jack socket (only for playing music)
- Battery capacity: 2500 mAh (lithium ion rechargeable battery)
- Charging time: 2-3 h
- Battery life: ca. 10 h
- Dimensions: W 122.6 x H 60.65 mm
- Weight: 435 g

Package contents

- 1 x Mobile Conference Room Speaker, Bluetooth & USB-compatible
- 1 x USB connection cable (USB A / Micro B)
- 1 x Audio connection cable (3.5 m)
- 1 x Bluetooth USB receiver
- 1 x QIG

Logistics						
	Number (pcs)	Weight (kg)	Depth (cm)	Width (cm)	Height (cm)	cm ³
Packaging Unit Carton	20	11.00	31.00	34.00	39.20	41,316.80
Packaging Unit Inside	1	0.55	0.00	0.00	0.00	0.00
Packaging Unit Single	1	0.55	15.80	14.40	7.10	1,615.39
Net single without Packaging	1	0.44	6.10	12.30	12.30	0.00

More images:

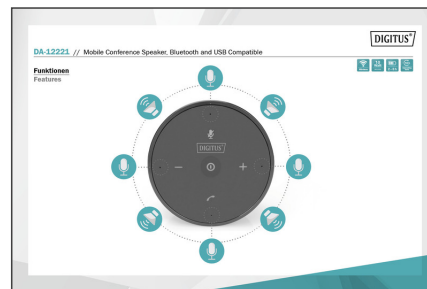
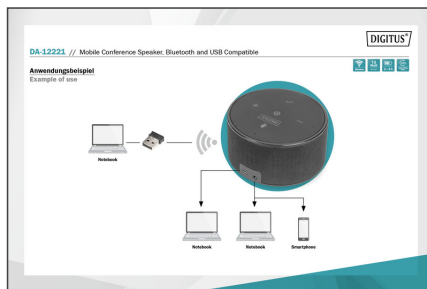
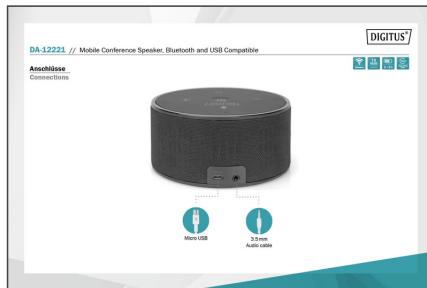

Safety notes

- If the device is powered by a plug-in power supply, ensure that the power adapter is connected correctly and meets the specified requirements (e.g. voltage and current).
- Only use certified CAT5e or CAT6 cables to ensure stable signal transmission.
- For particularly long cable runs or in environments prone to interference, it is recommended to use shielded network cables.
- Make sure that all connections are tight and secure to avoid loose contacts that could affect the signal quality. Make sure that the HDMI and Ethernet connections are properly connected.
- Make sure that the CAT cable is not laid near high-voltage power lines or other strong sources of electromagnetic interference to avoid signal interference.
- Only operate the device within the specified temperature range.
- Do not use the device outdoors or in damp or wet environments
- Check all connections and cables regularly for wear or damage. Cables and connections can wear out, especially with frequent use or long installations, which can lead to poor signal quality or system failure.

EU responsible person

EU based economic operator ensuring the product complies with the required regulations.

ASSMANN Electronic GmbH
Auf dem Schüffel 3
Lüdenscheid, Germany
<https://www.assmann.com>
info@assmann.com