

DIGITUS Mini DisplayPort ativo em cabo adaptador HDMI

AK-340416-002-W
EAN 4016032427490

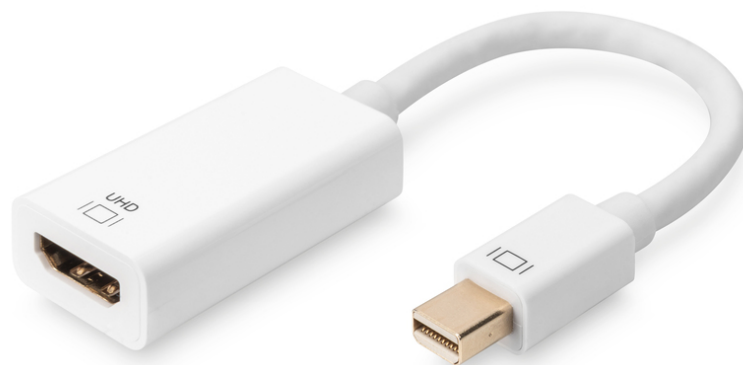

DisplayPort adapter cable, mini DP - HDMI type A M/F, 0,2m, HDMI 2.0, active, CE, gold, wh

O conversor Mini DisplayPort 4K para HDMI (conector Mini DisplayPort em conector fêmea DVI) permite-lhe reproduzir os conteúdos dos seus computadores ou computadores portáteis directamente na sua televisão. Ao mesmo tempo, suporta uma resolução de até 4096 x 2160. Assim, o utilizador pode mostrar as suas fotografias, vídeos, documentos, apresentações, etc. em Ultra HD, sendo ótimo para utilização em reuniões ou para utilização privada.

Suporta funcionalidade HDMI 2.0

- Integra um recetor DisplayPort completo e um transmissor HDMI completo para conversação em formato vídeo
- Integra um transmissor HDMI 2.0, que suporta vídeos até 4K x 2K@60Hz, 4K x 2K@30HZ e 1080P/3D.
- Suporta DP++ modo duplo
- Suporta DisplayPort 1.2 e 4 pistas a 1,62 Gbps, 2,7 Gbps e 5,4 Gbps
- Suporta proteção de conteúdos Full HDCP 1.4/2.2
- Cor profunda de 24bit

- Formatos de entradas áudio: 8 canais LPCM, formato áudio comprimido (AC-3, DTS) e HBR áudio até um tamanho de amostra áudio de 24 bits e velocidade de fotogramas de 192 khz.

Attributes

- AWG: 32
- Color cable: white
- Color connector: white
- Connector 1: Mini DP, plug
- Connector 2: HDMI type A, jack
- Connector surface: nickel-plated
- DisplayPort standard: DisplayPort 1.2
- Ferrite filter: none
- HDTV Standard: Ultra HD 4K
- Hoods: molded
- Interlock: none
- Wire material: CU
- Length: 0.2 m
- AOC - Active Optical Cable: no
- Shielding: Double shielding

Logistics						
	Number (pcs)	Weight (kg)	Depth (cm)	Width (cm)	Height (cm)	cm ³
Packaging Unit Carton	200	6.70	38.10	30.20	24.10	27,729.90
Packaging Unit Inside	10	0.34	33.00	27.90	7.60	6,997.32
Packaging Unit Single	1	0.03	20.00	15.00	1.52	456.00
Net single without Packaging	1	0.03	23.20	3.50	1.40	0.00

More images:

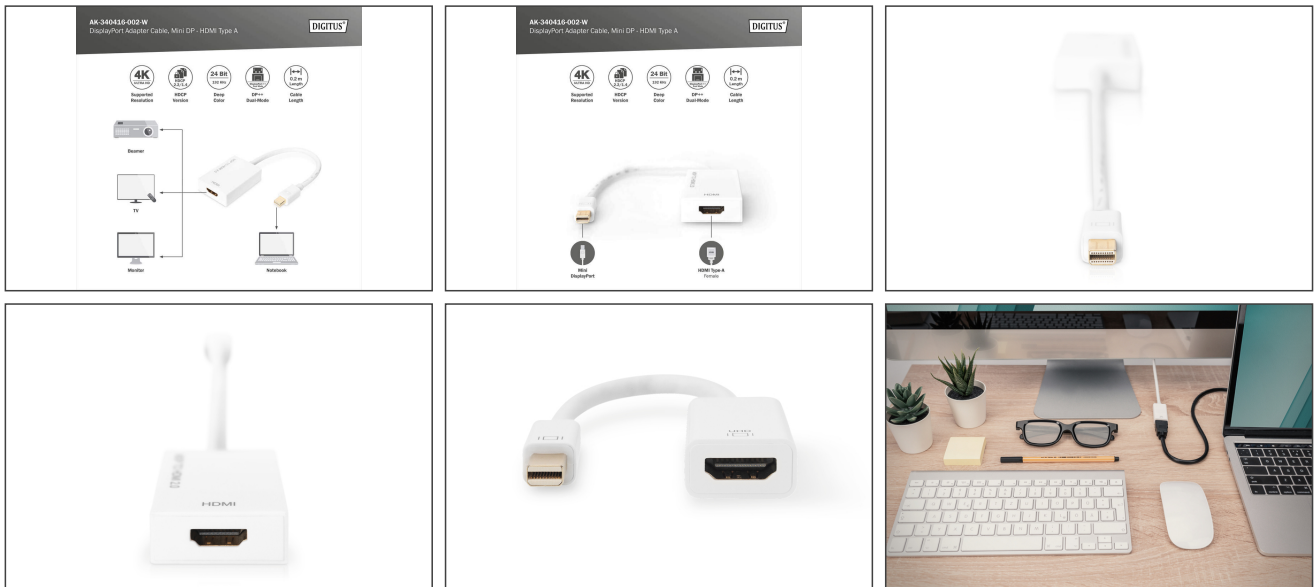

Safety notes

- When plugging and unplugging the cable, only grasp the plug and do not pull directly on the cable.
- Cables must not be kinked sharply or bent at tight angles, as this can damage the inner wires and lead to failures.
- Make sure that the cables are not under tensile load, as this can damage the insulation and the wires inside the cable.
- Ensure that cables are not laid in areas where they can be easily damaged mechanically.
- Cables should not be used in environments with extremely high or very low temperatures. Observe the product information on the maximum operating temperature of the cable
- Check cables regularly for visible damage such as cracks, kinks or signs of wear. Defective cables should be replaced immediately to avoid failures, short circuits or even electric shocks.

EU responsible person

EU based economic operator ensuring the product complies with the required regulations.

ASSMANN Electronic GmbH
 Auf dem Schüffel 3
 Lüdenscheid, Germany
<https://www.assmann.com>
info@assmann.com