

DIGITUS 4K HDMI® Audio Extractor for HDMI® / Stereo 2.0 / Toslink™ 5.1

DA-70475

EAN 4016032472575



4K HDMI Audio Extractor HDMI to HDMI/3.5mm/Toslink

Using the DIGITUS® HDMI® Audio Extractor, you can uncouple the audio signal from the HDMI® signal, allowing you to reproduce audio through your external speaker, surround system, amplifier or headphones – this way, you always output the audio signal to the device of your choice and in optimal quality. The image is output in brilliant 4K via the HDMI® output; you can connect a TV, monitor or project here. Perfect for your home cinema! Sound can be output in Stereo 2.0 through a 3.5mm jack socket or in 5.1 channel technology via Toslink™ (SPDIF/optical). The integrated HDMI® signal booster also improves the video signal (Full HD up to 20 m, 4K up to 10 m). The extractor is supplied with power over the enclosed USB cable and does not require a separate power adapter.

Extracts audio signals from an HDMI® signal – for music systems, headphones or recording devices

- Input: 1 x HDMI®
- Outputs: 1 x HDMI®, 1 x Toslink™ (SPDIF), 1 x Stereo jack 3.5 mm
- Supports high-resolution HDMI® signals up to 4K/60Hz (3840x2160p)
- Supports HDMI™ bandwidths up to 18 Gbps / 600 MHz (6 Gbps per channel)
- Supports color depths up to 12-bit (4K/60Hz, 1080p/60Hz, 720p/60Hz, 1080i/60Hz)

- Supports 3D formats of up to 600 MHz
- Supported HDCP version: 2.2 / 1.4
- Supports uncompressed audio content such as LPCM
- Supports compressed audio content
- Supported HDMI audio formats: DTS-HD/ Dolby-True HD
- Power supply: Micro USB
- Power consumption: 2 W max.
- Operating temperature: 0 °C to +45 °C
- Operating humidity: 10% to 85% RH (non-condensing)
- Storage temperature: -10 °C to +80 °C
- Storage humidity: 5% to 90% RH (non-condensing)
- Dimensions: L 55 x W 55 x H 16 mm
- Weight: 55 g

Attributes

- HDTV Resolution max.: 3840 x 2160 Pixel, 60Hz
- Audio: yes
- Signal input: HDMI
- Signal output: HDMI

Package contents

- 1 x 4K HDMI® Audio Extraktor für HDMI® / Stereo 2.0 / Toslink™ 5.1
- 1 x USB Connection cable
- 1 x QIG

Logistics						
	Number (pcs)	Weight (kg)	Depth (cm)	Width (cm)	Height (cm)	cm³
Packaging Unit Carton	40	6.90	28.00	57.00	25.50	40,698.00
Packaging Unit Inside	10	1.73	13.00	27.50	23.50	8,401.25
Packaging Unit Single	1	0.17	18.50	11.50	2.50	531.88
Net single without Packaging	1	0.06	5.50	5.50	1.60	0.00

More images:

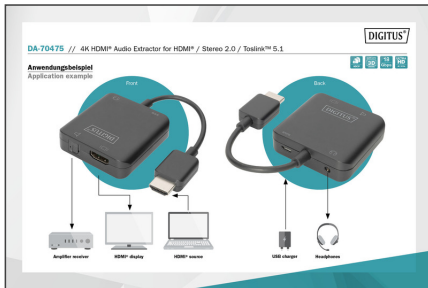
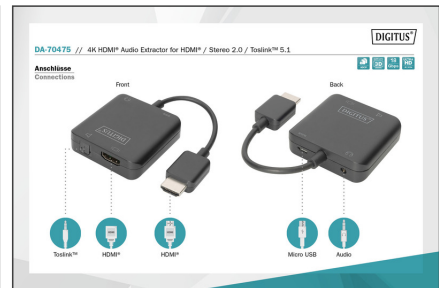

Safety notes

- If the device is powered by a plug-in power supply, ensure that the power adapter is connected correctly and meets the specified requirements (e.g. voltage and current).
- Only use certified CAT5e or CAT6 cables to ensure stable signal transmission.
- For particularly long cable runs or in environments prone to interference, it is recommended to use shielded network cables.
- Make sure that all connections are tight and secure to avoid loose contacts that could affect the signal quality. Make sure that the HDMI and Ethernet connections are properly connected.
- Make sure that the CAT cable is not laid near high-voltage power lines or other strong sources of electromagnetic interference to avoid signal interference.
- Only operate the device within the specified temperature range.
- Do not use the device outdoors or in damp or wet environments
- Check all connections and cables regularly for wear or damage. Cables and connections can wear out, especially with frequent use or long installations, which can lead to poor signal quality or system failure.

EU responsible person

EU based economic operator ensuring the product complies with the required regulations.

ASSMANN Electronic GmbH
Auf dem Schöffel 3
Lüdenscheid, Germany
<https://www.assmann.com>
info@assmann.com