

DIGITUS KVM Switch, 2 Port, Dual Display, 4K, HDMI®

DS-12860
EAN 4016032467168



Desktop HDMI KVM Switch

With the DIGITUS® 2-Port KVM Switch for dual displays, you can operate two 4K-compatible PCs using a single USB keyboard and mouse combination. By pressing a button or hot key, you can switch comfortably between the two PCs and are spared the trouble of replugging all cables. Output on up to two monitors is provided via two HDMI® outputs on the rear side. You can also switch between the audio signals for the microphone and speaker. In addition, a USB port is included on the front side for use with other peripheral devices like USB sticks or external hard drives on both PCs. The connected peripheral devices are each assigned to the active PC. Status LEDs on the front side of the switch show you the current configuration at all times. The slim switch features the added benefits of sturdy metal housing.

Operate 2 PCs with dual display using a USB keyboard and mouse combination – switch between two computers by pressing a button

- UHD resolution: 4K / 30 Hz (3840 x 2160p) / subsampling: YUV 4:4:4
- Inputs: 4 x HDMI® inputs (2x2), 2 x USB B, 2 x audio combo socket 3.5 mm jack (microphone, loudspeaker)
- Outputs (console): 2 x HDMI®, 2 x USB A (mouse, keyboard), 2 x stereo audio 3.5m jack (microphone, speakers)
- Additional connection on the front: 1 x USB A for additional peripheral devices such as printers or USB sticks

- HDMI® version: 1.4b
- USB specification: USB 2.0 compliant (FullSpeed)
- Supported audio formats: Dolby True HD, DTS HD Master Audio
- Switching between the PCs: Switch on the front panel or hot keys
- Status LED on front panel shows current configuration
- The device is platform-independent and suitable for all operating systems
- Operating temperature: 0°C ~ 80°C
- Storage temperature: -20°C ~ 60°C
- Operating humidity: 0 - 80% RH (non-condensing)
- Housing material: metal
- Device power supply: USB power supply or optional 9 V DC power supply unit
- Dimensions: 13.2 x 9.2 x 6.6 cm (WxDxH)
- Weight: 575 g
- Power supply: AC 100-240V
- Power consumption: 2.7 W
- DC plug size: 5.5*2.1mm

Package contents

- 1 x KVM Switch, 2-Port, Dual Display, 4K, HDMI®
- 2 x HDMI® cable
- 2 x KVM cable (HDMI, USB, Audio)
- 1 x QIG

Logistics						
	Number (pcs)	Weight (kg)	Depth (cm)	Width (cm)	Height (cm)	cm³
Packaging Unit Carton	12	15.14	39.50	45.00	48.00	85,320.00
Packaging Unit Inside	1	1.26	0.00	0.00	0.00	0.00
Packaging Unit Single	1	1.26	18.50	22.50	9.30	3,871.12
Net single without Packaging	1	0.58	9.40	13.20	4.40	0.00

More images:

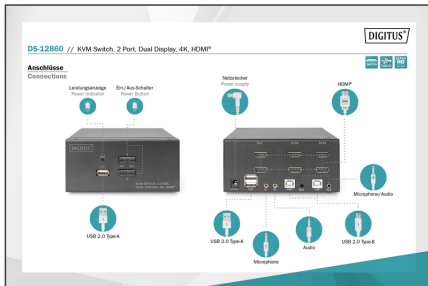
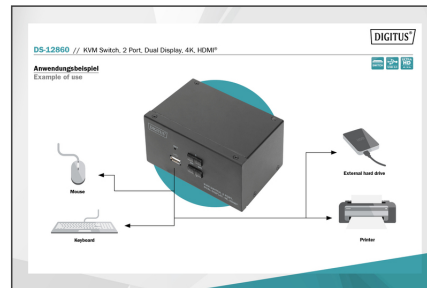
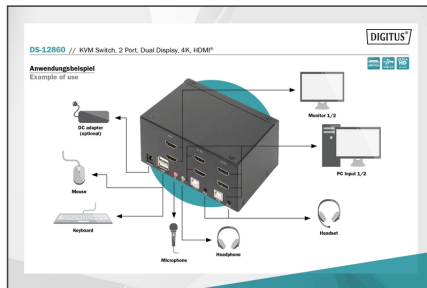

Safety notes

- Overloading can lead to overheating and damage to the appliance or the connected peripherals.
- If necessary, use an external power supply to ensure stable performance.
- If devices such as external hard disks or printers that require a high power consumption are connected, the device should be used with an external power supply. Otherwise, the device could be overloaded or functional problems could occur.
- Do not expose the device to rain, moisture, vapors or liquids.
- Do not insert any objects into the device.
- Do not attempt to repair the unit or open the housing without authorization. You risk an electric shock!
- Ensure adequate ventilation to prevent damage due to overheating.
- Dust, moisture, vapors and strong cleaning agents or solvents can cause damage to the device.
- Disconnect the appliance from the power supply and the connected devices before cleaning.
- Clean the device with a dust-free cloth.

EU responsible person

EU based economic operator ensuring the product complies with the required regulations.

ASSMANN Electronic GmbH
Auf dem Schüffel 3
Lüdenscheid, Germany
<https://www.assmann.com>
info@assmann.com