

DIGITUS Gigabit Active 802.3af PoE Midspan

DN-95131

EAN 4016032486107



Gigabit Ethernet PoE Injektor, 802.3af 802.3af, 15,4 W, small housing, white

DN-95131 is an indoor rated active PoE midspan Injector specially designed for complex backhaul and networking applications. It provides 48Vdc, 0.32A power for remote PDs over 2 pairs output. It supports both 10/100 Base-T and Gigabit device. It works for 15.4W PoE PDs, such as wireless APs, WLAN routers, Network cameras, IP Phones, Microwave Radio and other power Ethernet terminals. It fully complies to IEEE802.3af PoE standard. Enclosed in an IP40 fire retardant plastic case. It works with a wide input voltage of 100-240 VAC, 50 or 60 Hz. It has detection chip inside, which will detect and classify PD before powering it. It will not provide power until a standard-compliant PD is detected.

The effective distance is 100 meters over Cat5e/Cat6 cables. It is small in size but high performance.

- IEEE802.3 10Base-T Ethernet
- IEEE802.3u 100Base-Tx Fast Ethernet
- IEEE802.3ab 1000Base-T Gigabit Ethernet
- Full compliant with IEEE802.3af PoE standard
- RoHS Compliance
- WEEE Compliance
- Input :100-240Vac 0.5A 50/60Hz

- Output: 48Vdc 320mA
- Power Pins: 4/5(+), 7/8(-)
- Data Speed: 10/100/1000Mbps
- Operating Temperature: 0° to 40°
- Operating Humidity: 20% to 80%, non-condensation
- Storage Temperature: -20° to 70°
- Storage Humidity: 10% to 90%, non-condensation
- Operating Altitude: up to 2000meters
- Safety Approvals: CE/FCC
- Case: Plastic
- Color: White
- IP Rated: IP40
- Size: 85mm X 30mm X 46mm
- Weight: 100g
- Power Indicator : Yellow
- PoE Load Indicator : Green

Attributes

- Industrial usage: no

Package contents

- DN-95131 PoE Injector
- Power Cord x 1
- Manual x 1

Logistics						
	Number (pcs)	Weight (kg)	Depth (cm)	Width (cm)	Height (cm)	cm ³
Packaging Unit Carton	40	1.29	35.50	43.50	22.00	33,973.50
Packaging Unit Inside	1	0.03	0.00	0.00	0.00	0.00
Packaging Unit Single	1	0.03	10.00	16.80	4.30	722.40
Net single without Packaging	1	0.00	10.00	16.80	4.30	722.40

More images:

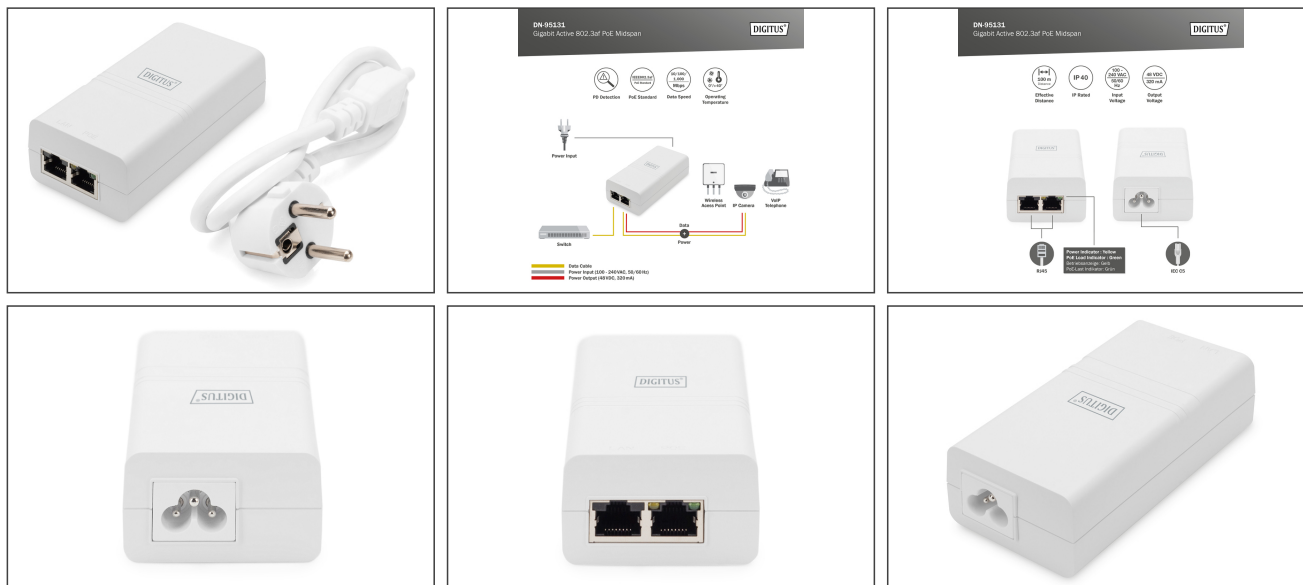

Safety notes

- This product is intended for indoor use only.
- Read all instructions and follow all warnings and instructions on the device.
- Do not place this appliance on an unstable surface (such as a trolley, stand, table, etc.).
- Do not use this appliance near water.
- Do not place this appliance near or above a radiator.
- The housing is equipped with openings for heat dissipation and ventilation. To prevent overheating during operation, the ventilation openings must not be blocked or covered.
- Do not place the appliance on a soft surface (e.g. bed, sofa, blanket, etc.). This will block the ventilation.
- The appliance must not be installed in a closed environment if adequate ventilation is not guaranteed.
- Do not spray any liquids onto the appliance.
- Disconnect the mains plug before cleaning. Do not use any liquid or foam cleaners.
- Clean the appliance with a damp cloth.
- Connect the device according to the power supply on the rating plate.
- To prevent damage to the appliance, it is important that all appliances are properly earthed.
- Do not place any objects on the power cable and lay it in such a way as to avoid tripping hazards.
- Use a surge protector, a regulator or an uninterruptible power supply (UPS) to protect your system from sudden, temporary and reduced power.
- Secure the system cable and mains cable properly and ensure that no objects are pressing on the cable.
- Do not insert any objects into the appliance through the openings in the housing. There is a risk of a short circuit, which can lead to fire or electric shock.
- Do not attempt to repair the appliance yourself. Always contact an authorized customer service centre.
- If any of the following conditions occur, unplug the appliance and return it to an authorized service centre for repair
- The mains cable, power supply unit or plug for the power supply is damaged or worn;
- Liquid has penetrated the appliance;
- The device has been exposed to rain or water;
- The device has been dropped or the housing has been damaged;
- The function of the device has obviously changed;
- The appliance cannot be operated as described in the operating instructions.

EU responsible person

EU based economic operator ensuring the product complies with the required regulations.

ASSMANN Electronic GmbH
Auf dem Schüffel 3
Lüdenscheid, Germany
<https://www.assmann.com>
info@assmann.com