

# X7CD shredder with CD/DVD/credit card shredder

DA-81607  
EAN 4016032459804



## Paper Shredder X7 with CD/DVD/Credit Card Slot 4x45mm, 7 sheets, 15L, Cross Cut

The X7 shredder easily destroys any kind of documents in a simple way. The device shreds up to 7 sheets into 4 x 45 mm small pieces. The automatic start/stop function ensures comfortable handling without switching the device on and off. The shredding process starts automatically in automatic mode when sheets are fed. Another highlight is the CD/DVD/credit card slot, which enables you to destroy your old bank cards and even CDs and DVDs in no time. The shredded plastic scraps land separately from paper in a separate container for easier disposal. The shredding unit can be easily removed using the integrated handle. Thanks to the integrated sight glass, you can see the filling level of the shredder without having to remove the shredding unit.

**The X7 shredder offers high security for your personal documents - ideal for use at home, in the home office or office.**

- Security level (DIN 66399): P-3
- Security level: 1
- Particle size: 4 x 45 mm (cross-cut)
- Average speed: 2.5 m/minute

- Shredding capacity: 7 sheets in one operation for optimal and fast data destruction
- Collection container with 15 litre capacity
- Safety shutdown when removing the shredding unit or the collection container
- Extra slot for CDs/DVDs and credit cards (max. 1 item per operation)
- Separate collection container for CDs/DVDs and credit cards for easy waste separation
- Tray 1 max. shredding capacity: seven (7) DIN A4 paper sheets
- Tray 2 max. shredding capacity: 1 CD/DVD or credit card
- Automatic start/stop function and reverse mode
- Paper feed width: 220 mm
- Noise level: approx. 74 dB
- Dimensions: H 39.2 x W 35.5 x D 18 cm
- Colour: Black

### Package contents

- X7 shredder
- User Manual
- Collection container

Logistics						
	Number (pcs)	Weight (kg)	Depth (cm)	Width (cm)	Height (cm)	cm <sup>3</sup>
Packaging Unit Carton	2	8.90	32.50	40.00	41.00	53,300.00
Packaging Unit Inside	1	4.45	20.00	38.00	31.00	23,560.00
Packaging Unit Single	1	4.45	20.00	38.00	31.00	23,560.00
Net single without Packaging	1	3.90	20.00	38.00	31.00	23,560.00

#### More images:

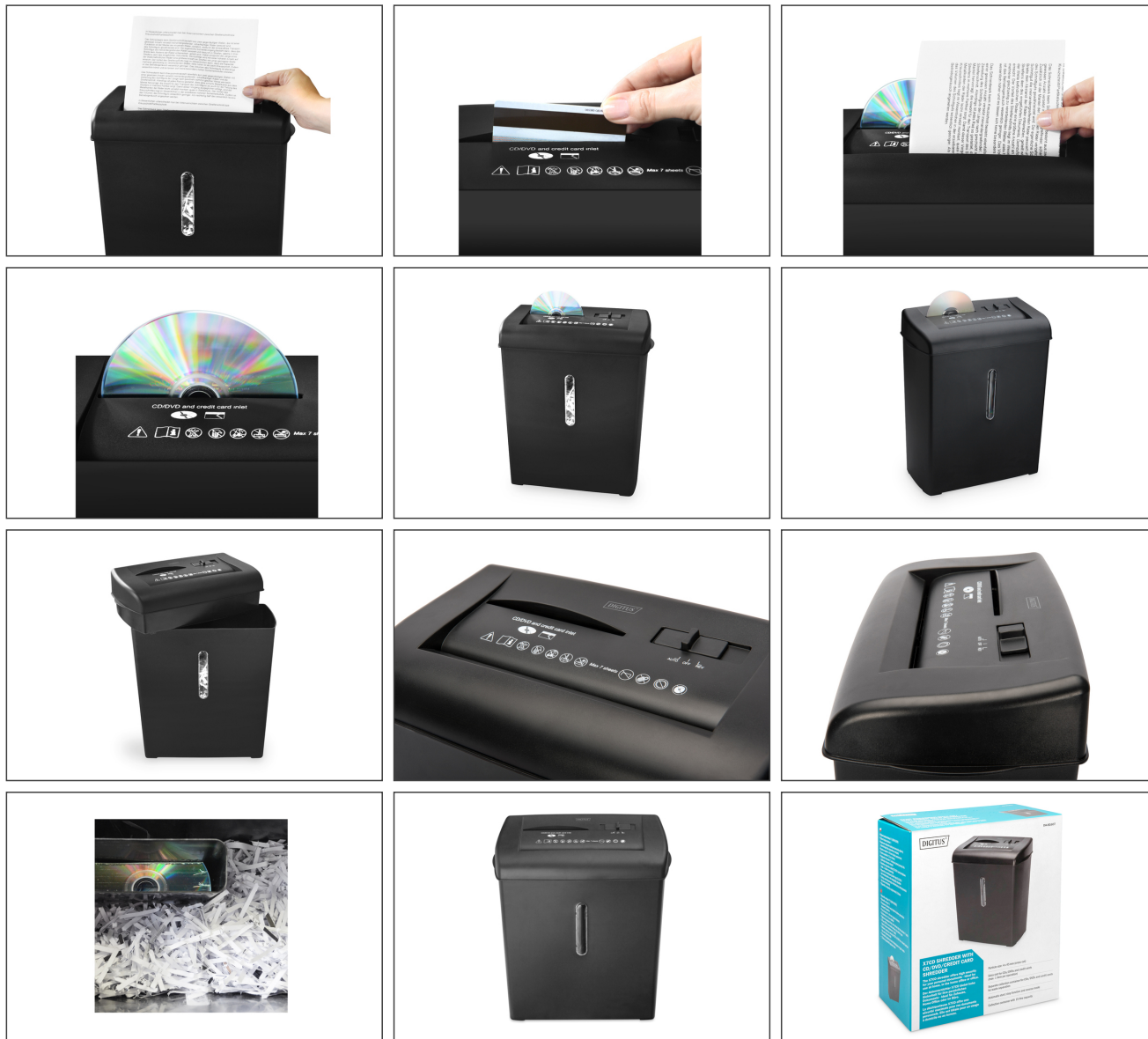

#### Safety notes

- Read the operating instructions carefully and completely before using the appliance for the first time.
- Always place the appliance on a level and dry surface. It must be freely accessible from all sides. It is not advisable to use an extension cable!
- Do not open the laminator or repair it yourself. Take it to your specialist dealer if it has been damaged or contact our service hotline.
- Only use film pockets of the correct size (max. up to A4) and thickness (80 to 100 micrometers). Foil pockets that are too thin can lead to a blockage inside the device.
- Do not touch any hot surfaces of the appliance after it has been put into operation.
- For safety reasons, the laminator must not be used by children unless they are supervised by an adult.
- Do not operate the appliance outdoors or near water.
- Do not use the device to hot laminate materials that are sensitive to heat, such as thermal fax paper. These materials are only suitable for cold lamination.
- Do not spill or pour any liquid on the appliance and do not allow it to enter the appliance.
- Do not insert any metal objects into the appliance. Do not reach into the appliance with your fingers.
- The laminator is not suitable for continuous commercial use. It is advisable to set the appliance switch to the "0" position for 30 minutes after it has been in operation for approx. 30 minutes.
- The socket outlet must be located near the appliance and must always be easily accessible.