

# DIGITUS® DisplayPort Adapter

AK-340602-000-S  
EAN 4016032289715



**DisplayPort Adapter, Type DP-HDMI A M/F,w/interlock, bl**

With this adapter you can connect a HDMI cable to the DP interface of your graphic card or Notebook, for example.

**Robust adapter, high mechanical load capacity**

- Support up to 1080p with 60Hz
- Support DP++ Dual-Mode
- Supported transmission modes: RBR, HBR, HBR2
- Maximal bandwidth: 10,8 Gbps
- HBR-Version/transfer mode: HBR1 (2,70 Gbit/s per lane)
- HDCP-Version: HDCP 1.3

**Attributes**

- Assortment: DisplayPort Cables
- Color connector: black
- Connector 1: DP, plug
- Connector 2: HDMI type A, jack
- Connector surface: nickel-plated
- DisplayPort standard: DisplayPort 1.1a
- HDTV Standard: Full HD
- Hoods: molded
- Interlock: Snap fastener
- Resolution max.: 1920 x 1080 Pixel, 60Hz
- Length: 0.1 m
- AOC - Active Optical Cable: no

| Logistics                    |              |             |            |            |             |        |
|------------------------------|--------------|-------------|------------|------------|-------------|--------|
|                              | Number (pcs) | Weight (kg) | Depth (cm) | Width (cm) | Height (cm) | cm³    |
| Packaging Unit Carton        | 460          | 9.00        | 32.00      | 50.00      | 21.00       | 33.60  |
| Packaging Unit Inside        | 20           | 0.39        | 21.00      | 15.00      | 3.00        | 945.00 |
| Packaging Unit Single        | 1            | 0.02        | 20.00      | 9.00       | 2.00        | 360.00 |
| Net single without Packaging | 0            | 0.01        | 2.00       | 6.00       | 2.00        | 24.00  |

**More images:**

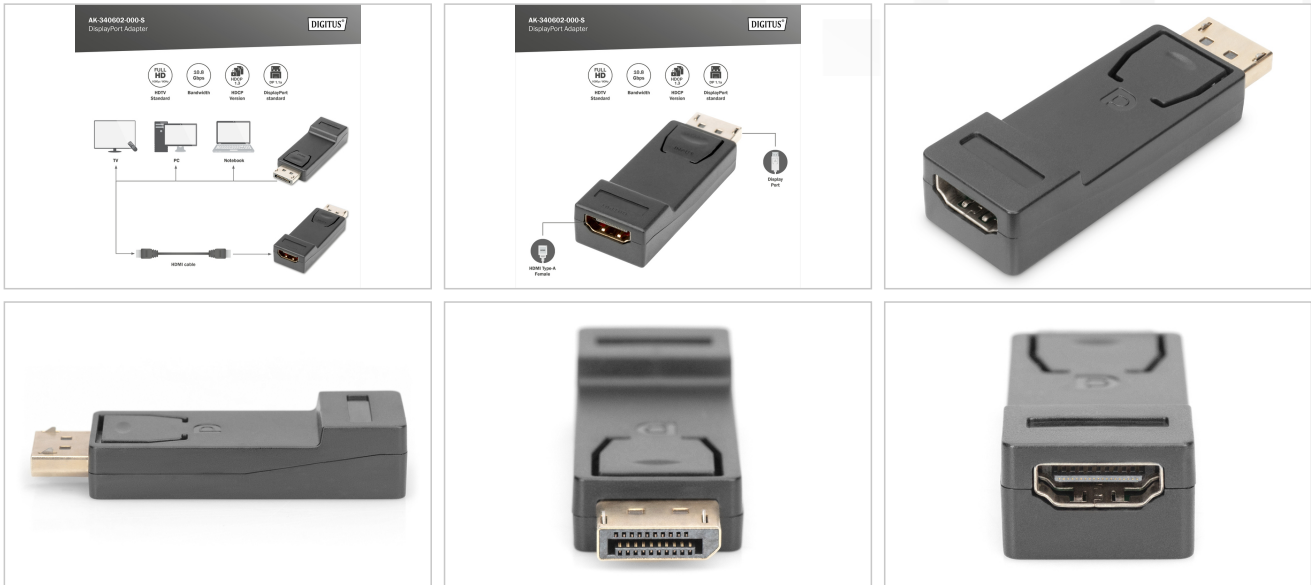

**Safety notes**

- When plugging and unplugging the cable, only grasp the plug and do not pull directly on the cable.
- Cables must not be kinked sharply or bent at tight angles, as this can damage the inner wires and lead to failures.
- Make sure that the cables are not under tensile load, as this can damage the insulation and the wires inside the cable.
- Ensure that cables are not laid in areas where they can be easily damaged mechanically.
- Cables should not be used in environments with extremely high or very low temperatures. Observe the product information on the maximum operating temperature of the cable
- Check cables regularly for visible damage such as cracks, kinks or signs of wear. Defective cables should be replaced immediately to avoid failures, short circuits or even electric shocks.

**EU responsible person**

EU based economic operator ensuring the product complies with the required regulations.

ASSMANN Electronic GmbH  
 Auf dem Schüffel 3  
 Lüdenscheid, Germany  
<https://www.assmann.com>  
[info@assmann.com](mailto:info@assmann.com)