

DIGITUS® SOHO Pro wall-mounted enclosure - 254 mm (10") - 315x300 mm (WxD)

DN-49104

EAN 4016032493662



10" 12U wall mounting cabinet, SOHO Pro 595 x 315 x 300 mm, unmounted, grey

Whether in the home, office or in sub-distribution boards with limited space: With the compact 254 mm (10") solutions from the SOHO Pro series, you can install your network wherever you want. Available in three height units (6U, 9U, 12U), the wall-mounted enclosures are equipped with a full glass door and a cable entry in the roof and base. A pair of galvanized 254 mm (10") profile rails labelled with legible height units are installed inside. These can be adjusted in depth. Each cabinet is a robust steel construction made of up to 1.5 mm thick sheet steel. The coloring takes the form of electrostatic powder coating in the standard colors grey (RAL 7035) and black (RAL 9005). The door hinges can be changed. The network enclosures are supplied unassembled in an optimized flat pack. Assembly takes place in just a few steps and is child's play thanks to the enclosed step-by-step instructions.

The DIGITUS® wall-mounted enclosure SOHO Pro series is characterized by efficient delivery in an optimized flat pack and particularly user-friendly installation.

- Protection class IP20
- Lockable safety glass door, type 9473
- 200° door opening angle
- 1-point locking on the front door
- 254 mm (10") profile rails mounted at the front inside the enclosure, galvanized

- 254 mm (10") profile rails are adjustable in depth
- 1.1 - 1.5 thick sheet steel with a high load-bearing capacity, powder-coated
- Cable entry with brush strip in the roof and with plastic cover in the floor
- Ventilation slots for active and passive ventilation
- Installation depth for components max.: 254 mm
- Product dimensions (H x W x D): 595 x 315 x 300 mm
- Packaging dimensions (H x W x D): 175 x 360 x 610 mm
- Weight (net / gross): 7.92 / 8.39 kg

Attributes

- Cabinet type: Wall mounting cabinet
- Color: light grey, RAL 7035
- Depth: 300 mm
- Front door: Glass door, single opening
- Load capacity: 30 kg
- Side panels: Both sides
- Units: 12
- Width: 316 mm
- IP protection class: IP20
- Mounted: no

Package contents

- 2x key
- 1x QIG

Logistics							
	Number (pcs)	Weight (kg)	Depth (cm)	Width (cm)	Height (cm)	cm³	
Packaging Unit Carton	1	8.39	61.00	36.00	17.50	38,430.00	
Packaging Unit Inside	1	8.39	61.00	36.00	17.50	38,430.00	
Packaging Unit Single	1	8.39	61.00	36.00	17.50	38,430.00	
Net single without Packaging	0	7.92	30.00	31.50	59.50	0.00	

More images:

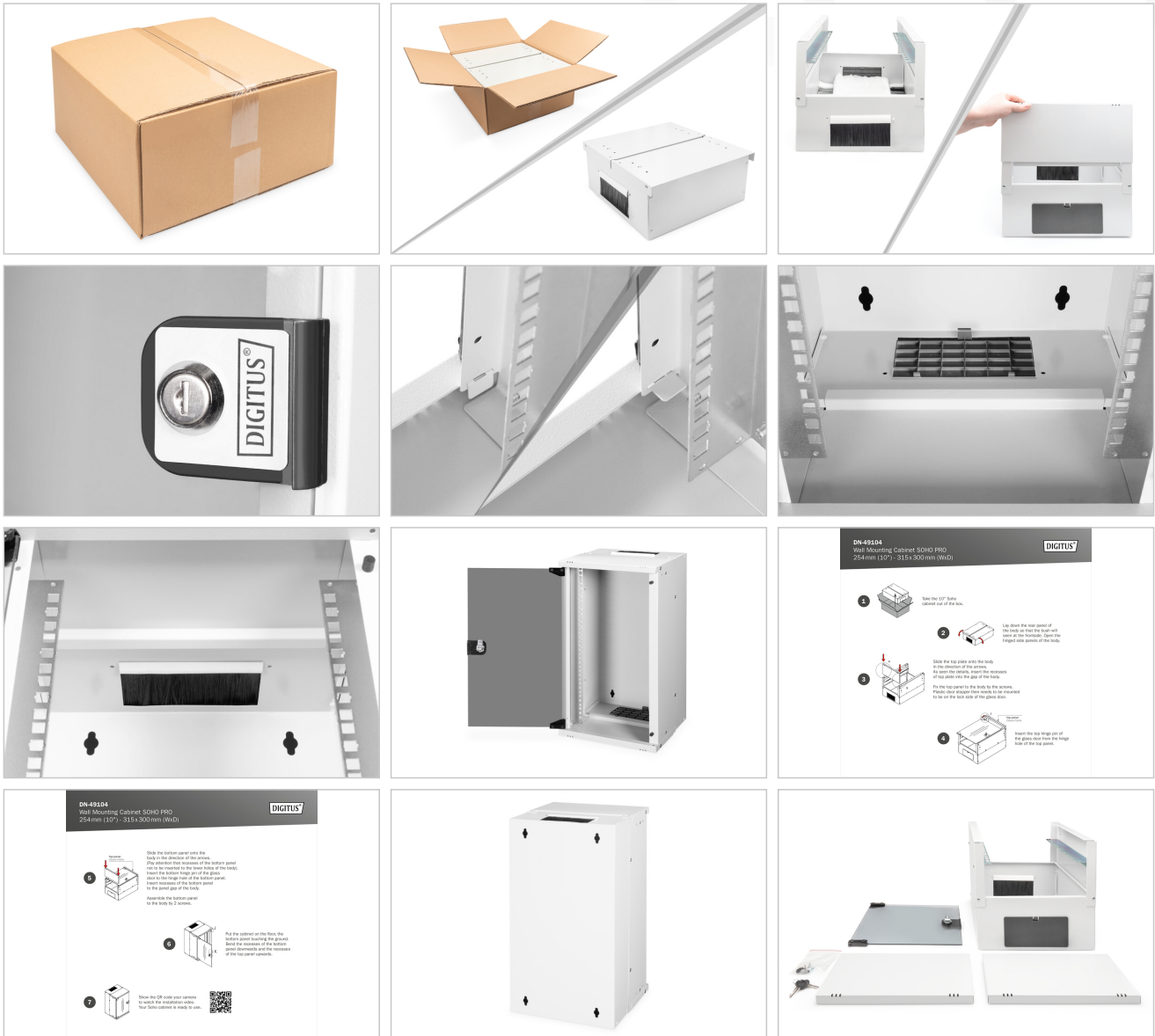

DN-45104
Wall Mounting Cabinet S01HD PRO
254mm (10") - 315 x 300mm (WxD)

DIGITUS

Slide the bottom panel into the body in the direction of the arrow. (Do not insert from behind of the bottom panel, but the bottom edge of the bottom panel into the larger hole of the bottom panel. Insert the bottom panel into the larger hole of the bottom panel for the panel edge of the body.)

Assemble the bottom panel for the body for 2 screws.

Put the cabinet on the floor like before you finished the ground. Check the position of the cabinet panel compared to the position of the top panel carefully.

Check the QR code your camera to watch the installation video. Your cabinet is ready to use.

DN-45104
Wall Mounting Cabinet S01HD PRO
254mm (10") - 315 x 300mm (WxD)

DIGITUS

1. Take out 10 screws cabinet out of the box.

2. Use them to screw panels of the body on front the top wall panel at the brackets. Tighten the panels of the body.

3. Slide the top plate into the body in the direction of the arrow. To open the cabinet, insert the lock key of top plate into the hole of the body. To the top panel to the body by the screws. Check that the screws are inserted to be on the lock side of the glass door.

4. Insert the top hinge pin of the glass door into the hinge hole of the top panel.