

DIGITUS USB-C 3.2 Gen1 - RJ45 Ethernet cable, 1Gbit/s, 10m

AK-300601-100-S
EAN 4016032502050



USB-C - RJ45 CAT 6A S/FTP Cable, 1 Gbit/s, 10m USB 3.2 Gen1, LSZH Jacket

With the Digitus USB-C 3.2 Gen1 - RJ45 Ethernet cable, you can easily connect your USB-C enabled device to a wired network and benefit from a stable and fast Gigabit Ethernet connection. The cable replaces the conventional Ethernet adapter and offers a space-saving, compact solution without additional devices. Ideal for laptops, tablets or smartphones that do not have an integrated LAN connection. It provides fast and reliable connections to the Internet - perfect for video streams, online meetings or data-intensive applications. Thanks to the support of Wake-On-LAN and "RealWoWi" (Wake-On-WAN) technology, you can even activate your device remotely. The safe LSZH (Low Smoke Zero Halogen) casing minimizes smoke development and toxic fumes in the event of fire - ideal for installations in public or sensitive areas. The plug-and-play installation enables immediate use, and the cable is fully compatible with macOS and Windows - without any additional drivers or external power supply. A versatile and secure solution for any setup!

Fast, reliable network connection via USB-C - ideal for modern devices without an Ethernet port. Experience gigabit speed and seamless plug-and-play installation.

- Speed: 10/100/1000 Mbps (supports Gigabit Ethernet)
- CAT version: CAT 6A S/FTP
- USB version: USB 3.2 Gen1, downward compatible
- Compatibility exists with the following operating systems up to their current versions: From Windows 7, from macOS 12, from iPhone 15 (iOS), from iPadOS 16, from Android 14, from ChromeOS 116.0.5845.120, from Linux 22.04 LTS
- Plug-and-play: without driver installation
- Supported: Wake-On-LAN, RealWoWi (Wake-On-WAN) for remote access
- Power: USB-powered, no external power supply required
- Aluminum housing for long-lasting use

- Outer diameter: 6.2 mm, AWG 26
- Chipset: RTL8153E
- Advanced functions:
- Pair-swap, polarity and distortion correction: Improves signal quality and ensures a stable connection, even in difficult network conditions
- Crossover detection and correction: Automatic correction of cable twists ensures reliable communication without connection problems
- Full-duplex flow control in accordance with IEEE 802.3x: Enables bidirectional data transmission simultaneously for efficient network communication
- On-chip buffer support: Temporary storage of data packets ensures stable and continuous data transmission
- Energy efficiency & standards:
- IEEE 802.1P Layer 2 Priority Encoding: Supports network prioritization to optimize performance during simultaneous use.
- IEEE 802.1Q VLAN tagging: Enables network segmentation and improved data management through VLAN support.
- IEEE 802.3az-2010 (EEE = Energy Efficient Ethernet): Supports energy-efficient Ethernet connections to reduce power consumption during low activity.
- Power save mode: Supports power save mode during power off or link power down for even more energy efficiency.

Attributes

- AWG: 26
- Color cable: black
- Connector 1: USB C, plug
- Connector 2: RJ45, plug
- Connector surface: nickel-plated
- USB compliance: USB 3.0 / 3.1
- Category: CAT 6A
- Length: 10 m

Logistics

| | Number (pcs) | Weight (kg) | Depth (cm) | Width (cm) | Height (cm) | cm³ |
|------------------------------|--------------|-------------|------------|------------|-------------|------|
| Packaging Unit Carton | 15 | 5.19 | 0.00 | 0.00 | 0.00 | 0.00 |
| Packaging Unit Inside | 1 | 0.00 | 0.00 | 0.00 | 0.00 | 0.00 |
| Packaging Unit Single | 1 | 0.00 | 0.00 | 0.00 | 0.00 | 0.00 |
| Net single without Packaging | 0 | 0.00 | 0.00 | 0.00 | 0.00 | 3.40 |

More images:

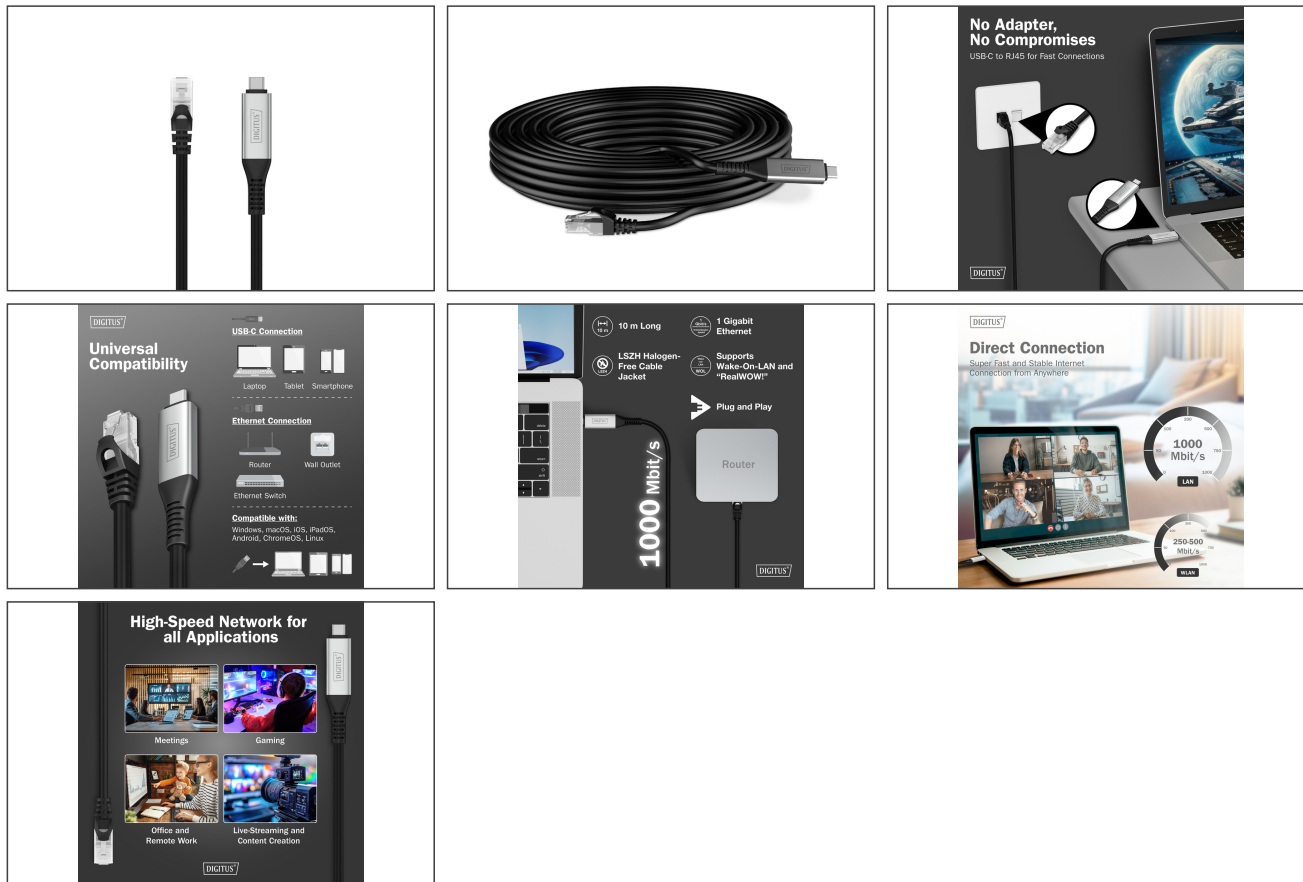

Safety notes

- When plugging and unplugging the cable, only grasp the plug and do not pull directly on the cable.
- Cables must not be kinked sharply or bent at tight angles, as this can damage the inner wires and lead to failures.
- Make sure that the cables are not under tensile load, as this can damage the insulation and the wires inside the cable.
- Ensure that cables are not laid in areas where they can be easily damaged mechanically.
- Cables should not be used in environments with extremely high or very low temperatures. Observe the product information on the maximum operating temperature of the cable
- Check cables regularly for visible damage such as cracks, kinks or signs of wear. Defective cables should be replaced immediately to avoid failures, short circuits or even electric shocks.

EU responsible person

EU based economic operator ensuring the product complies with the required regulations.

ASSMANN Electronic GmbH
 Auf dem Schüffel 3
 Lüdenscheid, Germany
<https://www.assmann.com>
info@assmann.com