

# DIGITUS® Advanced Barcode Scanner, Wireless

DA-81007

EAN 4016032508847



## Advanced Barcode Scanner, Wireless, 1D/2D 2m/s, 1280x1024, IP52

The Advanced Barcode Scanner (Wireless) offers maximum freedom of movement for professional working environments. Thanks to modern 2D scanning technology, it reliably captures all common 1D and 2D barcodes, including QR codes as well as pharmaceutical and GS1 standards. This makes it ideal for mobile applications in retail, logistics and the medical sector. Wireless use via 2.4G radio frequency or Bluetooth enables a flexible connection - either via the USB receiver supplied or directly with smartphones, tablets and laptops. With a range of up to 100 meters, the scanner supports efficient workflows without fixed workstations. The integrated offline memory also allows barcodes to be captured even without a permanent connection. Designed for continuous professional use, the scanner impresses with its robust construction and high reliability. The antibacterial housing makes it particularly suitable for hygienically sensitive areas such as pharmacies, laboratories and hospitals. The smooth surface enables quick and easy cleaning during everyday work. The IP52 protection rating protects against dust and dripping water, while the high impact resistance supports a long service life in everyday working life. With its easy commissioning, long battery life and ergonomic design, the Advanced Barcode Scanner (Wireless) is a reliable solution for anyone who wants to combine wireless flexibility and professional scanning performance.

### Wireless 2D barcode scanner for reliable capture of 1D and 2D barcodes including QR codes for professional applications in retail, logistics and healthcare.

- Scan technology: 2D area imager
- Light source: White illumination light, green target cross
- Image sensor: CMOS 1280 x 1024 pixels
- Scan angle: rotation angle  $\pm 360^\circ$ , inclination angle  $\pm 65^\circ$ , declination angle  $\pm 65^\circ$
- Reading precision:  $\approx 3$  mil
- Number of scans per second: 300 scans
- Reading distance:
- Code 39 (5 mil): 50 - 230 mm, EAN-13 (13 mil): 55 - 400 mm, QR Code (15 mil): 75 - 270 mm, Code 128 (5 mil): 65 - 220 mm
- Supported codes:

- 1D: Codabar, Code39, Code 32 Pharmaceutical (PARAF), Interleaved 2 of 5, NEC 2 of 5, Code 93, Straight 2 of 5 Industrial, Straight 2 of 5 IATA, Matrix 2 of 5, Code 11, Code 128, GS1-128, UPC-A, UPC-E, EAN/JAN-8, EAN/JAN-13, MSI, GS1 DataBar Omnidirectional, GS1 DataBar Limited, GS1 Data Expanded
- 2D: Codeblock A, Codeblock F, PDF417, Micro PDF417, GS1 Composite Codes, QR Code, Data Matrix, MaxiCode, Aztec, HANXIN
- Interface: USB-HID, USB-COM
- Scan modes: Manual mode, Continuous mode, Automatic detection mode
- Wireless communication:
- 2.4G RF (via USB-A connection) - Bluetooth (direct pairing with mobile devices)
- Range: up to 100 m (free field)
- Compatible operating systems: Windows / Android / iOS / Mac / Linux
- Scanner holder included
- Operating voltage: DC 5 V  $\pm 5\%$
- Battery: 2200 mAh lithium battery - Rechargeable via cable
- Operating time: approx. 7 hours, charging time: approx. 4 hours
- IP protection class: IP52 - Dust-protected / protection against dripping water
- Antibacterial housing: suitable for medical and healthcare applications
- Suitable for medical and healthcare applications: The material of the housing and the trigger has been tested for antibacterial properties against *Staphylococcus aureus* and *Escherichia coli* in accordance with standard GB 21551.2-2010
- Impact resistance: multiple drops from up to 3 m onto concrete
- Dimensions: 102 x 71 x 177 mm
- Weight: 224.2 g
- Material: Plastic
- Product color: White, Petrol
- Cable length (charging): 1,2 m
- Cable color: Black

### Package contents

- 1x Advanced Barcode Scanner, Wireless
- 1x supply cable 1.2m (USB-B - USB-A)
- 1 x 2.4G RF Receiver (USB A)
- 1x scanner holder
- 1x QIG

| Logistics                    |              |             |            |            |             |                 |
|------------------------------|--------------|-------------|------------|------------|-------------|-----------------|
|                              | Number (pcs) | Weight (kg) | Depth (cm) | Width (cm) | Height (cm) | cm <sup>3</sup> |
| Packaging Unit Carton        | 20           | 13.54       | 25.50      | 54.00      | 53.50       | 73,669.50       |
| Packaging Unit Inside        | 1            | 0.68        | 0.00       | 0.00       | 0.00        | 0.00            |
| Packaging Unit Single        | 1            | 0.68        | 12.60      | 24.00      | 10.00       | 3,024.00        |
| Net single without Packaging | 1            | 0.23        | 7.10       | 10.20      | 17.70       | 0.00            |

More images:

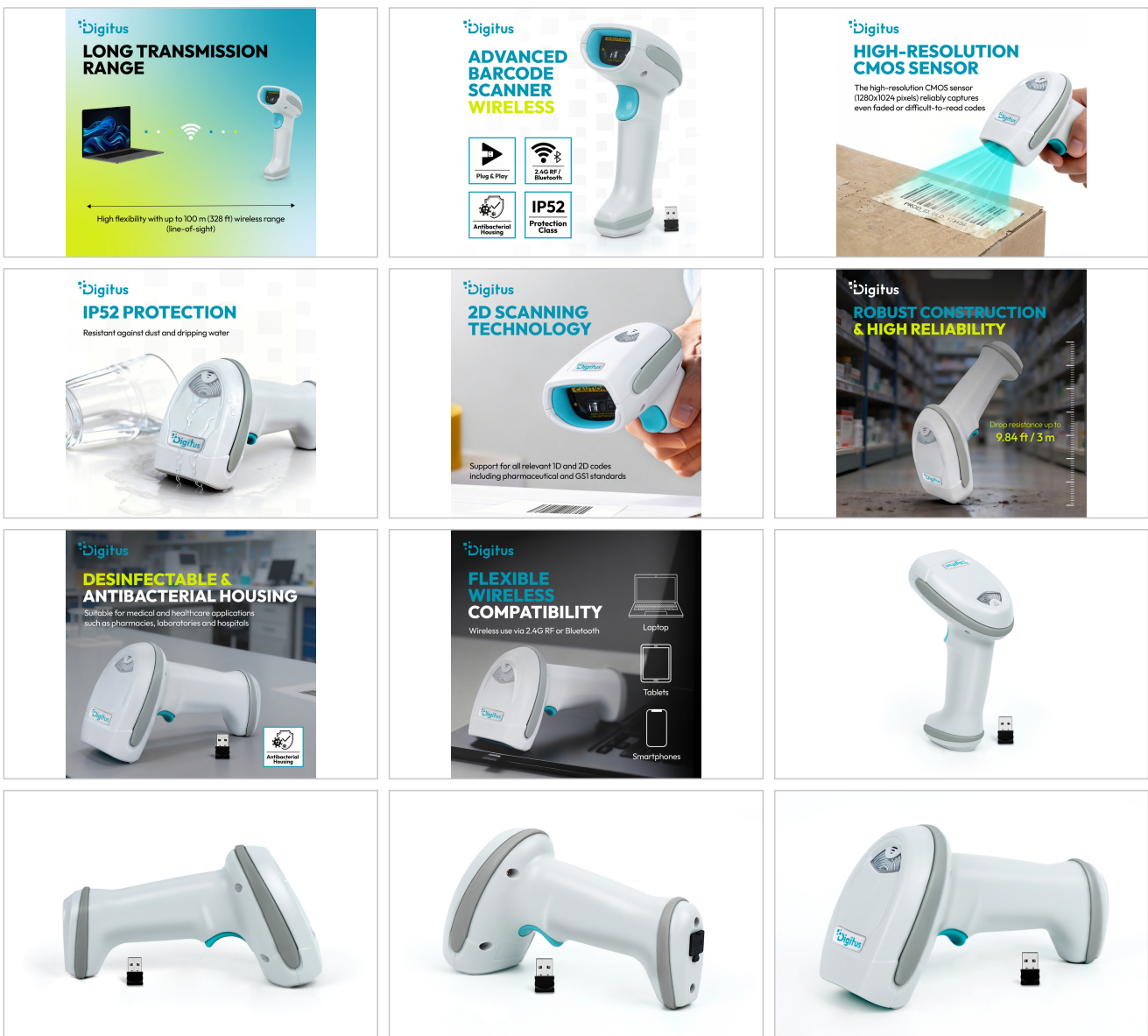

Safety notes

- Do NOT look directly into the LED light.
- Do not look at the light source either directly or using optical aids.

- Do NOT expose the reader to flammable substances.
- Under no circumstances should you attempt to carry out unauthorized repairs to the installed components.
- A socket outlet for the AC power supply should be available and easily accessible near the device. Ensure a stable power supply so that the reader and peripheral devices function correctly.
- Do not expose the device to rain, moisture, vapors or liquids.
- Do not insert any objects into the device.
- Do not attempt to repair the unit or open the housing without authorization. You risk an electric shock!
- Dust, moisture, vapors and strong cleaning agents or solvents can cause damage to the device.
- Disconnect the appliance from the power supply and the connected devices before cleaning.
- Clean the device with a dust-free cloth.

**EU responsible person**

EU based economic operator ensuring the product complies with the required regulations.

ASSMANN Electronic GmbH  
Auf dem Schüffel 3  
Lüdenscheid, Germany  
<https://www.assmann.com>  
[info@assmann.com](mailto:info@assmann.com)