

# Digitus® Single Monitor Mount, 49", 20 kg

DA-90473

EAN 4016032505914



## Single Monitor Mount, 49", 20 kg Mechanical Spring, VESA: 75x75, 100x100, Black

Powerful monitor mount for maximum flexibility and stability This fully mobile desk mount has been specially developed for large monitors up to 49 inches and a weight of up to 20 kg - ideal for demanding work environments and high-quality setups. Whether flat screen or curved display: the mount offers maximum stability and flexibility in a space-saving design. Thanks to the robust heavy-duty construction, it also supports heavy monitors effortlessly while allowing precise alignment in all directions. The integrated spring tension ensures fine adjustment of the weight so that the monitor can be brought into the desired position effortlessly - without any readjustment. The VESA quick-release function ensures maximum user-friendliness: the monitor can be mounted or removed quickly and easily. The innovative quick-release coupling also makes it easier to connect the two arm segments and significantly reduces the installation effort. With two flexible mounting options - table clamp or grommet - the mount can be attached to almost any workstation. The integrated 180° rotation stop prevents accidental knocks against walls or neighboring screens, while the clever cable management ensures a tidy, professional look. Ideal for users who value ergonomics, stability and functionality - whether in the office, studio or home office.

### Fully mobile table mount for screens up to 49" with a maximum weight capacity of 20 kg - suitable for flat screens as well as curved displays

- Maximum monitor size: 49"
- Maximum load: 20 kg
- Mechanical spring with tension adjustment
- VESA compatibility: 75x75, 100x100

- Suitable for flat and curved monitors
- Tilting the monitor: 70° (+ 50° to -20°)
- Pivoting the monitor: 180° (+90° to -90°)
- Rotating the monitor: 360° (+180° to -180°)
- Full arm extension: 54.5 cm
- Mounting type: Clamp bracket or table feed-through
- Recommended tabletop thickness: Clamp: 10 - 80 mm, table bushing: 10 - 35 mm
- VESA Quick-Release function (quick-release fastener)
- 180° rotation stop
- Integrated cable management
- Material: steel, aluminum, plastic
- Dimensions: D 13.4 x W 62.5 x H 66.3 cm
- Weight: 4.95 kg
- Color: Black
- Tested & certified ergonomic product - Certified by IGR (Institute for Health and Ergonomics)

### Attributes

- Monitor weight (max.): 20 kg
- Mounting method: Clamp-mount
- Number of monitors: 1
- Size of monitors: up to 49"
- VESA mount: 75x75 mm, 100x100 mm

### Package contents

- 1x monitor mount
- 1x mounting material & accessories
- 1x assembly instructions

Logistics						
	Number (pcs)	Weight (kg)	Depth (cm)	Width (cm)	Height (cm)	cm³
Packaging Unit Carton	2	11.80	22.00	45.50	26.50	26,526.50
Packaging Unit Inside	1	5.90	0.00	0.00	0.00	0.00
Packaging Unit Single	1	5.90	43.50	20.50	12.30	10,968.50
Net single without Packaging	1	4.95	13.40	62.50	66.30	0.00

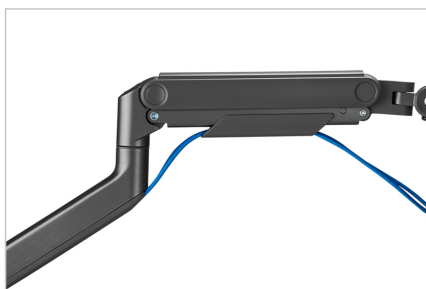
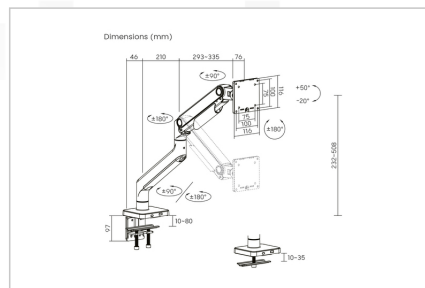

- Please read the entire manual before starting assembly and installation. Please contact your local dealer if you have any questions about the instructions or warnings.
- CAUTION: Use with products that exceed the permitted weight may result in damage or possible injury.
- Brackets should be fitted in accordance with the installation instructions. Incorrect installation can result in damage or injury.
- Use safety equipment and suitable tools. The product should only be installed by specialists.
- This product can be installed on timber-framed, solid concrete or stone walls.
- The load-bearing surfaces should be able to safely withstand the entire weight of appliances and all additional components.
- Only use the installation screws supplied and DO NOT TIGHTEN the screws TOO TIGHT.
- This product contains small parts that can cause a choking hazard if swallowed. Keep these parts away from children.
- Only use this product indoors. Using the product outdoors can lead to injuries and damage.
- IMPORTANT: Before installation, please compare all components received with the components list. If parts are damaged or missing, ask your local dealer for replacement parts.
- MAINTENANCE: Check the bracket regularly for safety and stability (preferably every three months).

EU based economic operator ensuring the product complies with the required regulations.

Zertifiziert durch  
**IGR** Institut  
für Gesundheit  
und Ergonomie  
[www.igr-ev.de](http://www.igr-ev.de)