

# DIGITUS USB-C 3.2 Gen1 - RJ45 Ethernet cable, 1Gbit/s, 3m

AK-300601-030-S  
EAN 4016032502036



## USB-C - RJ45 CAT 6A S/FTP Cable, 1 Gbit/s, 3m USB 3.2 Gen1, LSZH Jacket

With the Digitus USB-C 3.2 Gen1 - RJ45 Ethernet cable, you can easily connect your USB-C enabled device to a wired network and benefit from a stable and fast Gigabit Ethernet connection. The cable replaces the conventional Ethernet adapter and offers a space-saving, compact solution without additional devices. Ideal for laptops, tablets or smartphones that do not have an integrated LAN connection. It provides fast and reliable connections to the Internet - perfect for video streams, online meetings or data-intensive applications. Thanks to the support of Wake-On-LAN and "RealWoWi" (Wake-On-WAN) technology, you can even activate your device remotely. The safe LSZH (Low Smoke Zero Halogen) casing minimizes smoke development and toxic fumes in the event of fire - ideal for installations in public or sensitive areas. The plug-and-play installation enables immediate use, and the cable is fully compatible with macOS and Windows - without any additional drivers or external power supply. A versatile and secure solution for any setup!

**Fast, reliable network connection via USB-C - ideal for modern devices without an Ethernet port. Experience gigabit speed and seamless plug-and-play installation.**

- Speed: 10/100/1000 Mbps (supports Gigabit Ethernet)
- CAT version: CAT 6A S/FTP
- USB version: USB 3.2 Gen1 (5Gbps), downward compatible
- Compatibility exists with the following operating systems up to their current versions: From Windows 7, from macOS 12, from iPhone 15 (iOS), from iPadOS 16, from Android 14, from ChromeOS 116.0.5845.120, from Linux 22.04 LTS
- Plug-and-play: without driver installation
- Supported: Wake-On-LAN, RealWoWi (Wake-On-WAN) for remote access
- Power: USB-powered, no external power supply required
- Aluminum housing for long-lasting use

- Outer diameter: 6.2 mm, AWG 26
- Chipset: RTL8153E
- Advanced functions:
- Pair-swap, polarity and distortion correction: Improves signal quality and ensures a stable connection, even in difficult network conditions
- Crossover detection and correction: Automatic correction of cable twists ensures reliable communication without connection problems
- Full-duplex flow control in accordance with IEEE 802.3x: Enables bidirectional data transmission simultaneously for efficient network communication
- On-chip buffer support: Temporary storage of data packets ensures stable and continuous data transmission
- Energy efficiency & standards:
- IEEE 802.1P Layer 2 Priority Encoding: Supports network prioritization to optimize performance during simultaneous use.
- IEEE 802.1Q VLAN tagging: Enables network segmentation and improved data management through VLAN support.
- IEEE 802.3az-2010 (EEE = Energy Efficient Ethernet): Supports energy-efficient Ethernet connections to reduce power consumption during low activity.
- Power save mode: Supports power save mode during power off or link power down for even more energy efficiency.

### Attributes

- AWG: 26
- Color cable: black
- Connector 1: USB C, plug
- Connector 2: RJ45, plug
- Connector surface: nickel-plated
- USB compliance: USB 3.0 / 3.1
- Category: CAT 6A
- Length: 3 m

## Logistics

	Number (pcs)	Weight (kg)	Depth (cm)	Width (cm)	Height (cm)	cm³
Packaging Unit Carton	40	5.85	32.00	50.00	21.00	33,600.00
Packaging Unit Inside	10	1.46	40.00	35.00	2.00	2,800.00
Packaging Unit Single	1	0.15	25.00	14.00	2.00	700.00
Net single without Packaging	1	0.00	18.00	9.00	2.00	0.00

**More images:**

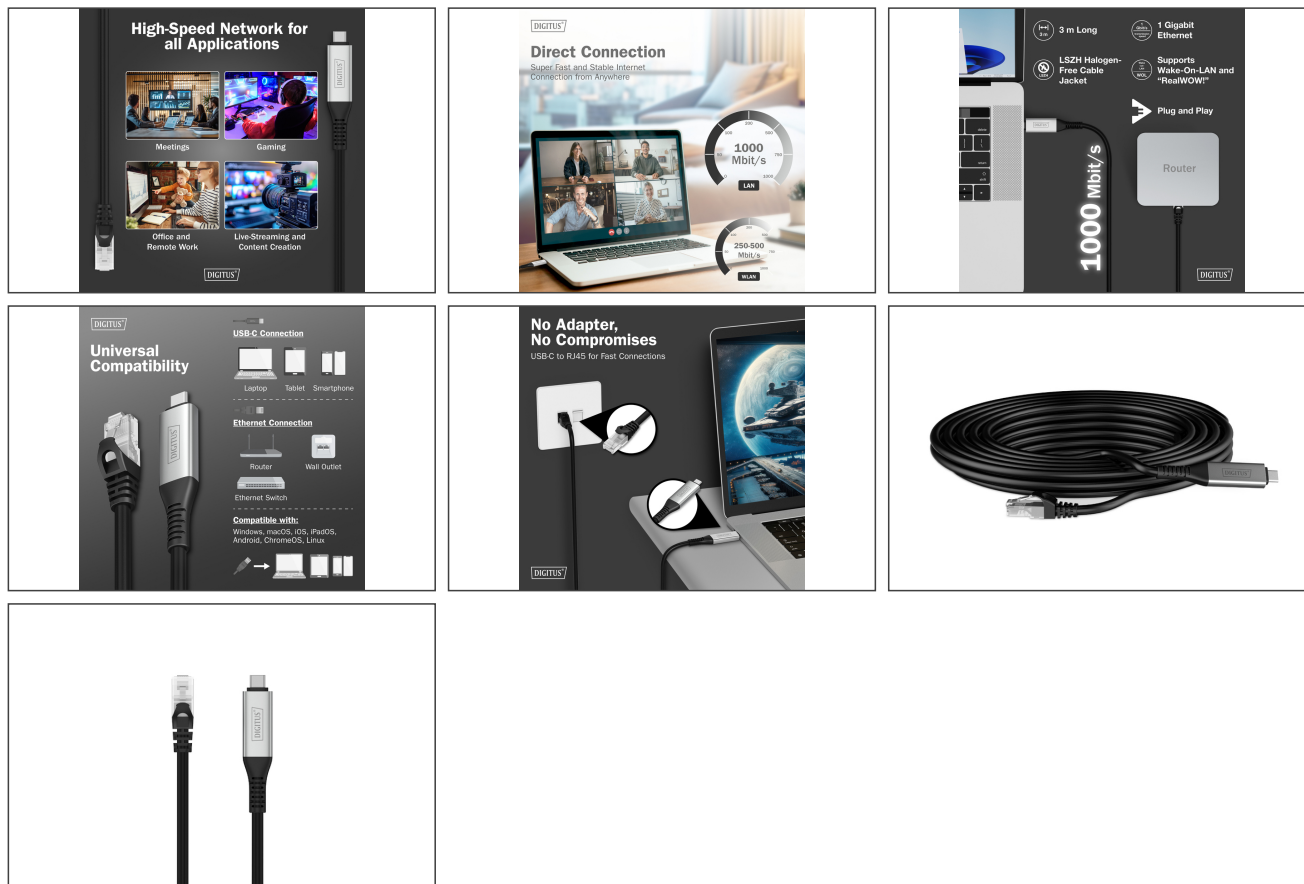

**Safety notes**

- When plugging and unplugging the cable, only grasp the plug and do not pull directly on the cable.
- Cables must not be kinked sharply or bent at tight angles, as this can damage the inner wires and lead to failures.
- Make sure that the cables are not under tensile load, as this can damage the insulation and the wires inside the cable.
- Ensure that cables are not laid in areas where they can be easily damaged mechanically.
- Cables should not be used in environments with extremely high or very low temperatures. Observe the product information on the maximum operating temperature of the cable
- Check cables regularly for visible damage such as cracks, kinks or signs of wear. Defective cables should be replaced immediately to avoid failures, short circuits or even electric shocks.

**EU responsible person**

EU based economic operator ensuring the product complies with the required regulations.

ASSMANN Electronic GmbH  
Auf dem Schüffel 3  
Lüdenscheid, Germany  
<https://www.assmann.com>  
[info@assmann.com](mailto:info@assmann.com)