

# DIGITUS® HDMI Fiber IP Extender Set, 4K/60Hz

DS-55350

EAN 4016032501886



## HDMI Fiber Extender Set 4K/60Hz, 40 km/300 m, Black

The HDMI Fiber IP Extender Set, 4K/60Hz is the ideal solution for high-quality HDMI signal transmission over long distances. It enables the transmission of UHD signals in 4K/60Hz (3840x2160p) with minimal latency of just 80-140 ms, so that content is reproduced in razor-sharp picture quality and with virtually no delay. Thanks to modern fiber optic technology, the system achieves a maximum transmission distance of up to 40 km in singlemode or up to 300 m in multimode, making it perfect for professional AV installations. By using existing 1G network infrastructures or additional 1G network switches, the extender set enables flexible and powerful signal transmission. In addition, the range can be extended as required by cascading, making unlimited distances possible. For additional flexibility, the system is compatible with LC & SC SFP modules as well as singlemode and multimode fiber optic cables. Suitable SFP modules are available separately (singlemode: DN-81002, multimode: DN-81000). In addition to the excellent picture quality, the extender set also offers separate audio output via a 3.5 mm stereo connection, which enables flexible sound transmission. An HDMI loop-out allows a local monitor to be connected directly to the transmitter unit (TX), while the integrated IR interface enables remote control of the input source from the output screen. With its long range, excellent picture quality and versatile expansion options, the HDMI Fiber IP Extender Set is the perfect choice for professional applications such as conference rooms, control centers, digital signage and broadcast studios.

### Enables HDMI signal transmission in UHD resolution (4K/60Hz) over a distance of up to 40 km (singlemode) / 300 m (multimode) in point-to-point connection

- Max. Resolution: Ultra HD 4K/60Hz (3840x2160p)
- Max. Range: Singlemode (SM) up to 40 km, multimode (MM) up to 300 m (point-to-point connection)
- HDMI 2.0
- HDCP 2.2 / 1.4
- Max. Video bandwidth: 18 Gbps
- Latency: 80-140 ms
- Max. HDMI cable length: 5 m
- Suitable for wall mounting
- Protection against short circuit, overvoltage, ESD (electrostatic discharge)
- Transmitter unit (TX) connections:
  - 1x HDMI input (4K/60Hz) - Signal source connection
  - 1x HDMI output (4K/60Hz) - local display connection
  - 1x SFP output (LC, SC) - SFP module connection
  - 1x IR output -reception of the IR signal

- 1x power supply connection (DC 5V/2A) - external power supply connection
- 1x RS232 Pass Through - control of connected devices
- 1x Micro USB - FW Update Port
- 1x 3.5 mm stereo audio input - separate audio output
- 1x reset button
- 2x status LED
- Receiver unit connections (RX):
  - 1x HDMI output (4K/60Hz) - Display connection
  - 1x SFP input (LC, SC) - SFP module connection
  - 1x IR input - forwarding of the IR signal
  - 1x power supply connection (DC 5V/2A) - external power supply connection
  - 1x RS232 Pass Through - control of connected devices
  - 1x Micro USB - FW Update Port
  - 1x 3.5 mm stereo audio output - separate audio output
  - 1x reset button
  - 2x status LED
- Operating temperature: -10° - 50° C
- Power consumption: TX approx. 7.5 W, RX approx. 7.5 W
- Compression: H.265
- Dimensions (1 unit): L 10.6 x W 10.3 x H 2.6 cm
- Weight: TX 290 g, RX 286 g
- Housing: Metal
- Color: Black

### Attributes

- HDTV-norma: Ultra HD 4K
- rezolucija maks.: 3840 x 2160 piksela, 60 Hz
- KVM: Ne
- PoE (napajanje preko Ethernet): Ne
- Priklučci za video vezu: HDMI
- Razmak: 40000 m
- Tehnologija prijenos: Vlakno

### Package contents

- 1x transmitter unit
- 1x receiver unit
- 2x mains adapter, EU plug (DC 5V/2A, 1.2 m)
- 2x IR cable/extension (1.0 m)
- 1x mounting material (wall mounting brackets, screws)
- 2x RS232 terminal block
- 2x earthing screws
- 1x operating instructions

Logistics						
	Number (pcs)	Weight (kg)	Depth (cm)	Width (cm)	Height (cm)	cm <sup>3</sup>
Packaging Unit Carton	10	12.10	42.00	27.00	38.00	43,092.00
Packaging Unit Inside	1	1.21	0.00	0.00	0.00	0.00
Packaging Unit Single	1	1.21	24.50	17.60	8.00	3,449.60
Net single without Packaging	1	0.58	10.60	10.30	2.10	0.00

More images:

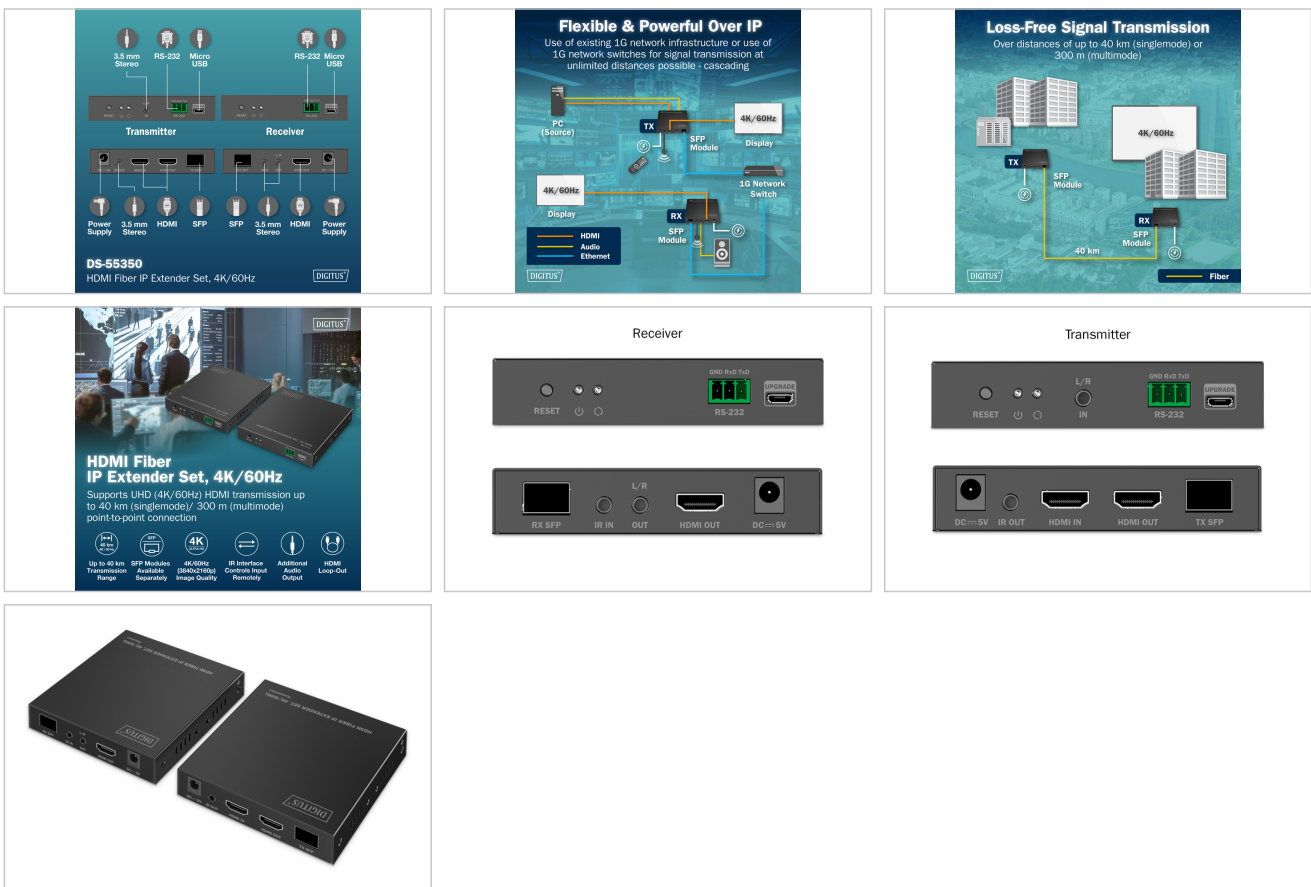

Safety notes

- If the device is powered by a plug-in power supply, ensure that the power adapter is connected correctly and meets the specified requirements (e.g. voltage and current).
- Only use certified CAT5e or CAT6 cables to ensure stable signal transmission.
- For particularly long cable runs or in environments prone to interference, it is recommended to use shielded network cables.
- Make sure that all connections are tight and secure to avoid loose contacts that could affect the signal quality. Make sure that the HDMI and Ethernet connections are connected correctly.
- Make sure that the CAT cable is not laid near high-voltage power lines or other strong sources of electromagnetic interference to avoid signal interference.
- Only operate the device within the specified temperature range.
- Do not use the device outdoors or in damp or wet environments
- Check all connections and cables regularly for wear or damage. Cables and connections can wear out, especially with frequent use or long installations, which can lead to poor signal quality or system failure.

**EU responsible person**

EU based economic operator ensuring the product complies with the required regulations.

ASSMANN Electronic GmbH  
Auf dem Schüffel 3  
Lüdenscheid, Germany  
<https://www.assmann.com>  
[info@assmann.com](mailto:info@assmann.com)