

# DIGITUS® DIGITUS USB-A 5V PoE Splitter

DN-95208

EAN 4016032482437



### Gigabit USB-A PoE Splitter USB Type A Female

DN-95208 is an indoor rated PoE USB-A splitter specially designed for complex backhaul and networking application. Enclosed in an IP40 fire retardant plastic case with compact design. It works as a converter to get power and data from PoE injector or PoE Switch of 802.3af/at over RJ45 connector then separate power and data to PDs. The output power is 5Vdc, 2.5A(max) via USB-A Female connector to PDs. Such as power communication station, wireless APs, network cameras, Tablet PC, and other USB-A devices. PoE signal into a separate data signal at 10/100Mbps. For planning purposes, the effective distance is 100 meters via Cat5e/Cat6 cables from Ethernet data source to PD.

### PoE splitter provides power 5Vdc, 2.5A(max) via USB-A Female connector and data signal at 10/100Mbps

- PoE Input :40-57Vdc PoE 802.3af/at
- USB Power Output: 5Vdc 2.5A(max)
- Data Output Speed: 10/100Mbps (RJ45)

- IEEE 802.3u , 802.3af/at
- IEEE 802.3u , 802.3af/at
- Operating Temperature: 0 to 40
- Wall-mountable
- IP40 rated Protection
- Input Power Pins: 4/5(+), 7/8(-) or 3/6(+),1/2(-)
- Size: 82.3 x34.7 x 19mm
- Attached cable length 124mm

### Attributes

- Broj priključaka: 1
- PoE norma: IEEE802.3at (PoE+)
- Ethernet brzina: Brzi Ethernet
- Industrijska uporaba: Ne

### Package contents

- USB PoE splitter
- Manual x1

Logistics						
	Number (pcs)	Weight (kg)	Depth (cm)	Width (cm)	Height (cm)	cm <sup>3</sup>
Packaging Unit Carton	40	5.94	35.50	43.50	22.00	33,973.50
Packaging Unit Inside	1	0.15	0.00	0.00	0.00	0.00
Packaging Unit Single	1	0.15	9.70	16.50	4.00	640.20
Net single without Packaging	1	0.07	3.40	8.20	1.90	0.00

**More images:**

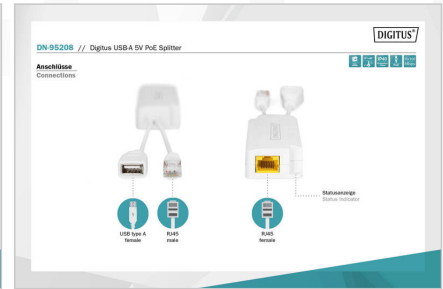
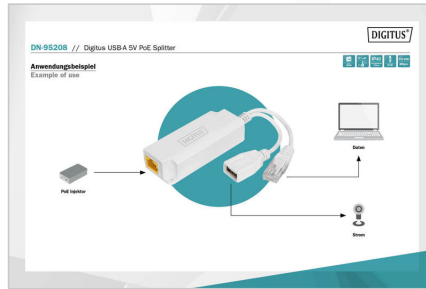

**Safety notes**

- This product is intended for indoor use only.
- Read all instructions and follow all warnings and instructions on the device.
- Do not place this appliance on an unstable surface (such as a trolley, stand, table, etc.).
- Do not use this appliance near water.
- Do not place this appliance near or above a radiator.
- The housing is equipped with openings for heat dissipation and ventilation. To prevent overheating during operation, the ventilation openings must not be blocked or covered.
- Do not place the appliance on a soft surface (e.g. bed, sofa, blanket, etc.). This will block the ventilation.
- The appliance must not be installed in a closed environment if adequate ventilation is not guaranteed.
- Do not spray any liquids onto the appliance.
- Disconnect the mains plug before cleaning. Do not use any liquid or foam cleaners.
- Clean the appliance with a damp cloth.
- Connect the device according to the power supply on the rating plate.
- To prevent damage to the appliance, it is important that all appliances are properly earthed.
- Do not place any objects on the power cable and lay it in such a way as to avoid tripping hazards.
- Use a surge protector, a regulator or an uninterruptible power supply (UPS) to protect your system from sudden, temporary and reduced power.
- Secure the system cable and mains cable properly and ensure that no objects are pressing on the cable.
- Do not insert any objects into the appliance through the openings in the housing. There is a risk of a short circuit, which can lead to fire or electric shock.
- Do not attempt to repair the appliance yourself. Always contact an authorized customer service centre.
- If any of the following conditions occur, unplug the appliance and send it to an authorized service centre for repair
  - The mains cable, power supply unit or plug for the power supply is damaged or worn;
  - Liquid has penetrated the appliance;
  - The device has been exposed to rain or water;
  - The device has been dropped or the housing has been damaged;
  - The function of the device has obviously changed;
- The appliance cannot be operated as described in the operating instructions.

**EU responsible person**

EU based economic operator ensuring the product complies with the required regulations.

ASSMANN Electronic GmbH  
 Auf dem Schüffel 3  
 Lüdenscheid, Germany  
<https://www.assmann.com>  
[info@assmann.com](mailto:info@assmann.com)