

DIGITUS HDMI KVM IP Extender Set

DS-55507

EAN 4016032478935



HDMI KVM Extender Set over IP 150 m, Full HD 1080p

The HDMI KVM IP Extender Set comprises a transmitter unit (positioned locally) as well as a receiver unit (positioned at a distance). The HDMI signal can be extended using a network cable (CAT 5e, 6, 6A, 7, 8) up to a maximum distance of 150 m (point-to-point connection). The HDMI signal can also be extended to an unlimited distance using the existing network infrastructure or using standard IP network switches (IP connection). The highest supported video resolution is Full HD (1920x1200/60 Hz, 4:4:4). The set also enables convenient access to a computer (mouse and keyboard) using the USB ports on the receiver unit. The set is perfectly suited for industrial, commercial and public sector applications.

Extends the HDMI signal to up to 150 m and offers KVM functionality to control the signal source via keyboard and mouse on the receiver unit

- HDMI 1.4
- 6.75 Gbps video bandwidth
- Supports Full HD, 1920x1200/60 Hz, 4:4:4
- HDCP 1.4
- Supports CAT 5e, 6, 6A, 7, 8 network cable
- Maximum transmission distance: 150 m (point-to-point connection)
- Supports H.265 encoding/decoding
- USB 1.1
- Compression: H.265
- Transmitter unit connections:
 - 1x HDMI input (1920x1200/60Hz) - Connection signal source
 - 1x RJ45 output - Connection CAT transmission cable
 - 1x USB-B input - Connection host PC for use of KVM functionality
 - 1x IR output - Connection of IR transmitter
 - 1x Power adapter input (DC 5V/1A) - Connection for external power adapter
- Receiver unit connections:

- 1x HDMI output (1920x1200/60Hz) - Connection output device
- 1x RJ45 input - Connection CAT transmission cable
- 2x USB-A (1.1) input - Connection of mouse and keyboard
- 1x IR input - Connection of IR receiver
- 1x Power adapter input (DC 12V/1A) - Connection for external power adapter
- ESD protection
- Operating temperature: -10-50 °
- Power consumption: Transmitter approx. 1.4W, Receiver approx. 1.7W
- Housing: Metal
- Dimensions (1 unit): L 9.15 x W 6.7 x H 1.75 cm
- Weight: Transmitter 155 g, Receiver 150 g
- Color: Black

Attributes

- HDTV Resolution max.: 1920 x 1200 Pixel, 60Hz
- HDTV Standard: Full HD
- Category: CAT 5e
- Distance: 150 m
- KVM: yes
- PoE (Power over Ethernet): no
- Transmission technology: IP
- Video connection ports: HDMI

Package contents

- 1x Transmitter unit
- 1x Receiver unit
- 1x IR transmission cable (1.5 m)
- 1x IR receiver cable (1.5 m)
- 2x Power adapter (DC 12V/1A, 1.15 m)
- 1x USB-B-A cable (1.5 m)
- 1x User manual

Logistics

	Number (pcs)	Weight (kg)	Depth (cm)	Width (cm)	Height (cm)	cm³
Packaging Unit Carton	20	3.10	38.80	40.00	29.00	45,008.00
Packaging Unit Inside	1	0.16	0.00	0.00	0.00	0.00
Packaging Unit Single	1	0.16	13.50	18.50	7.50	1,873.12
Net single without Packaging	1	0.16	9.20	6.70	1.80	0.00

More images:

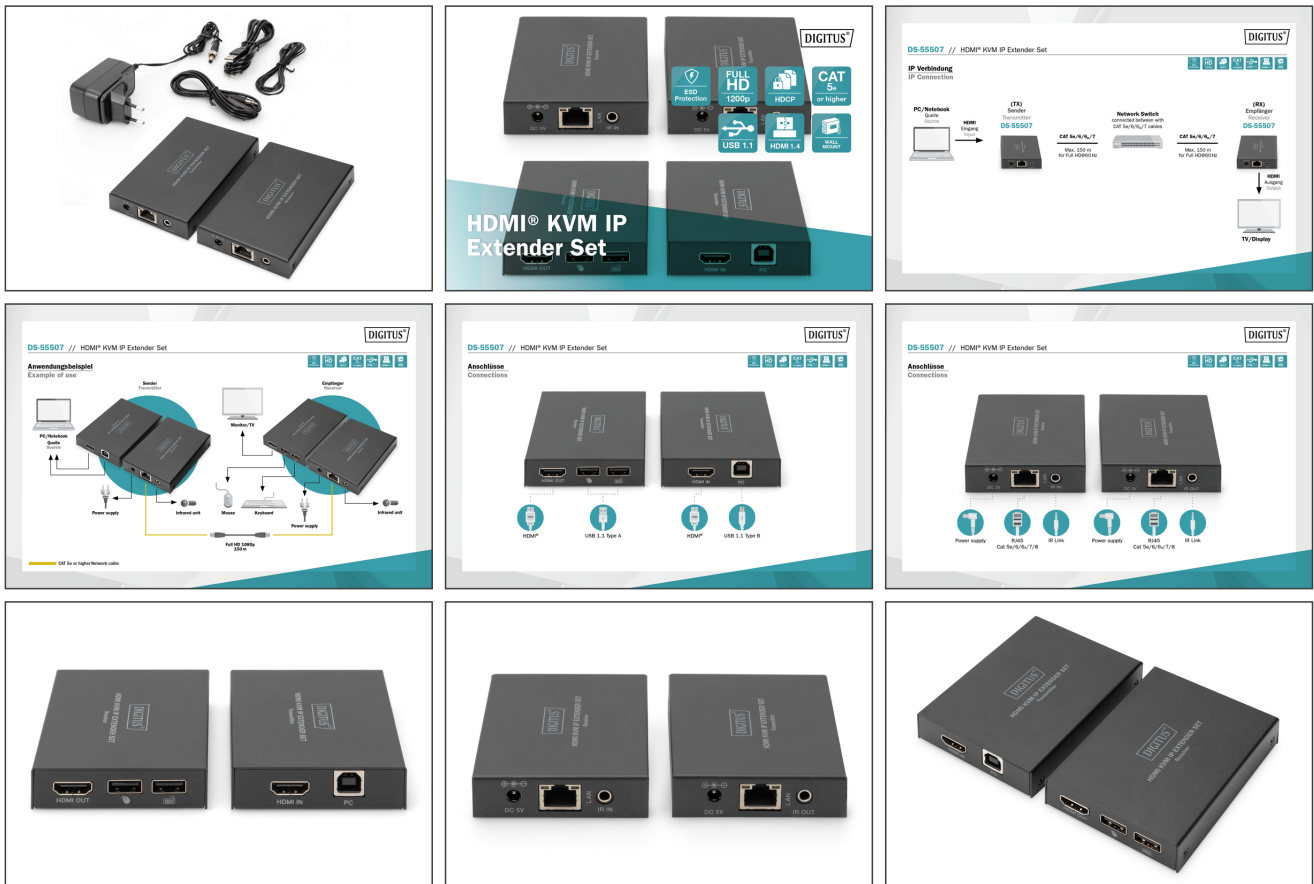

Safety notes

- If the device is powered by a plug-in power supply, ensure that the power adapter is connected correctly and meets the specified requirements (e.g. voltage and current).
- Only use certified CAT5e or CAT6 cables to ensure stable signal transmission.
- For particularly long cable runs or in environments prone to interference, it is recommended to use shielded network cables.
- Make sure that all connections are tight and secure to avoid loose contacts that could affect the signal quality. Make sure that the HDMI and Ethernet connections are connected correctly.
- Make sure that the CAT cable is not laid near high-voltage power lines or other strong sources of electromagnetic interference to avoid signal interference.
- Only operate the device within the specified temperature range.
- Do not use the device outdoors or in damp or wet environments
- Check all connections and cables regularly for wear or damage. Cables and connections can wear out, especially with frequent use or long installations, which can lead to poor signal quality or system failure.

EU responsible person

EU based economic operator ensuring the product complies with the required regulations.

ASSMANN Electronic GmbH
Auf dem Schüffel 3
Lüdenscheid, Germany
<https://www.assmann.com>
info@assmann.com