

# DIGITUS® USB Type-C™ Gigabit Ethernet Adapter 2.5G, USB-C™ + USB A (USB3.1/3.0)

DN-3028

EAN 4016032473572



### USB3.0/USB C 3.1 to 2.5G Ethernet Adapter

With the USB Type-C™ Gigabit Ethernet adapter, you can add a network connection to your notebook or desktop PC and achieve speeds of up to 2.5 Gbps. Plug and Play – Just plug in and get started. Power supply is provided conveniently via the USB-C™ interface. In addition, the USB A included in delivery allows for use with older USB jacks, downward compatible with USB 3.0 and below. The adapter is compatible with Windows, macOS, Linux and iOS. Suitable for online gamers, live streamers, 4K video applications and everyone who needs high network data rates with optimal performance. Thanks to its compact dimensions, the adapter also makes an ideal travel companion. The finishing touch is its elegant and resistant aluminum housing with lateral openings for improved heat dissipation and performance.

### Extend your notebook with USB-C™ / USB A connection to include a Multi-Gigabit network connection (RJ45) with up to 2.5 Gbps

- Supports USB-C™ connections with USB 3.1
- Supports USB A connections with USB 3.0
- Gigabit data transmission with up to 2.5 Gbps
- RJ45 Ethernet jack with LED feature display
- Supported data transfer rates: 10/100/1000/2500 Mbps
- Chipset: RTL8156B (improved power, data flow and performance)

- Supports: Wake-On-LAN, IPv4/IPv6 protocols, IEEE 802.3/IEEE 802.3u/IEEE 802.3ab/IEEE 802.3az/IEEE 802.3bz(Energy Efficient Ethernet)
- Full duplex / Half-duplex data flow control – auto-negotiation
- Auto MDI-X: Supports patch and crossover cable, automatic detection and switching
- Compatible with Windows, macOS, Linux and iOS
- Operating temperature: 0 °C to +40 °C
- Operating humidity: 20% to 80% (non-condensing)
- Power supply via USB-C™ (4.75 – 5.25 V)
- Stand-by power consumption: <60 mA
- Power consumption during operation: <80 mA @ 10Mbps, <130 mA @ 100Mbps, <300mA @ 1000Mbps, <460 mA @ 2.5 Gbps
- Cable length: 15 cm
- Material: Stable and resistant aluminum housing (anodized)
- Dimensions: L 110 x W 39.8 x D 16.6 mm
- Weight: 55 g
- Color: Gray

### Package contents

- 1x USB Type-C™ Gigabit Ethernet Adapter 2.5G, USB-C™+ USB A (USB3.1/3.0)
- 1x Instructions

Logistics						
	Number (pcs)	Weight (kg)	Depth (cm)	Width (cm)	Height (cm)	cm³
Packaging Unit Carton	125	11.00	35.00	46.00	35.00	56,350.00
Packaging Unit Inside	1	0.09	0.00	0.00	0.00	0.00
Packaging Unit Single	1	0.09	11.00	11.60	2.50	319.00
Net single without Packaging	1	0.06	1.70	11.00	4.00	0.00

**More images:**

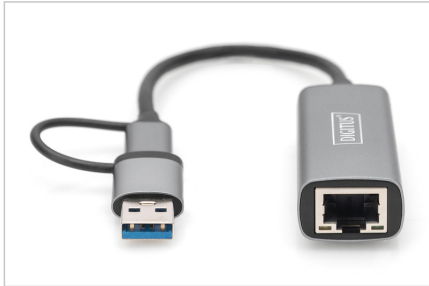
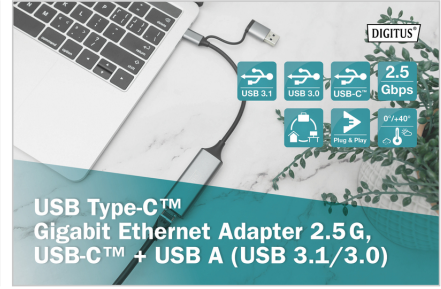
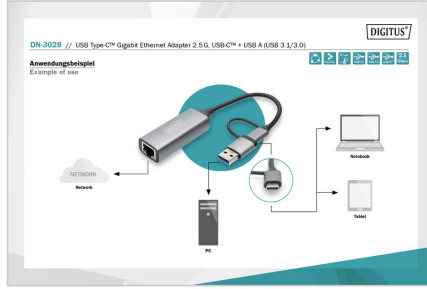
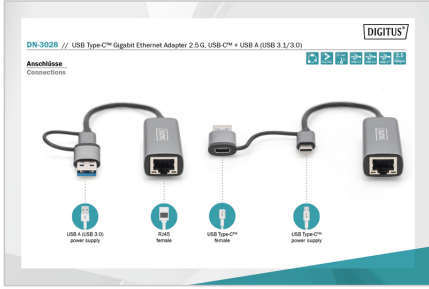

**Safety notes**

- Overloading can lead to overheating and damage to the appliance or the connected peripherals.
- If necessary, use an external power supply to ensure stable performance.
- If devices such as external hard disks or printers that require a high power consumption are connected, the device should be used with an external power supply. Otherwise, the device could be overloaded or functional problems could occur.
- Do not expose the device to rain, moisture, vapors or liquids.
- Do not insert any objects into the device.
- Do not attempt to repair the unit or open the housing without authorization. You risk an electric shock!
- Ensure adequate ventilation to prevent damage due to overheating.
- Dust, moisture, vapors and strong cleaning agents or solvents can cause damage to the device.
- Disconnect the appliance from the power supply and the connected devices before cleaning.
- Clean the device with a dust-free cloth.

**EU responsible person**

EU based economic operator ensuring the product complies with the required regulations.  
 ASSMANN Electronic GmbH  
 Auf dem Schüffel 3  
 Lüdenscheid, Germany  
<https://www.assmann.com>  
[info@assmann.com](mailto:info@assmann.com)