

DIGITUS® Suporte triplo para monitor, 3x 27", 3x 6 kg

DA-90363

EAN 4016032425571



Suporte triplo para monitor, 15-27", prateado capacidade de carga máxima de 6 kg, VESA máximo 100x100

O suporte de mesa universal permite a instalação de monitores LED e LCD de todas as marcas até um tamanho de 69 cm (27"). Graças ao braço com mola de pressão a gás, pode fixar o monitor a qualquer altura. Para selecionar um suporte de monitor adequado, tenha apenas em atenção as dimensões VESA e o peso do seu monitor.

Suporte de mesa triplo universal com mola de pressão a gás para um ajuste totalmente flexível do monitor em 4 níveis

- Passagem de cabos integrada
- Adequado para distâncias padrão VESA de 75 x 75 e 100 x 100 mm
- Carga máx. Carga 6 kg por braço
- Peso: 7,4 kg

- Dimensões: 150 x 1588 x 410 mm
- Produto ergonómico testado e certificado - Certificado pelo IGR (Instituto de Saúde e Ergonomia)

Attributes

- Monitor weight (max.): 6 kg
- Mounting method: Clamp-mount
- Number of monitors: 3
- Size of monitors: up to 27"
- VESA mount: 75x75 mm, 100x100 mm

Package contents

- Suporte para monitor
- Parafusos para montagem do monitor
- Instruções de utilização

Logistics						
	Number (pcs)	Weight (kg)	Depth (cm)	Width (cm)	Height (cm)	cm ³
Packaging Unit Carton	2	18.40	59.50	48.50	31.50	90,901.10
Packaging Unit Inside	1	9.20	13.50	57.00	46.30	35,627.90
Packaging Unit Single	1	9.20	13.50	57.00	46.30	35,627.90
Net single without Packaging	1	7.40	11.80	158.80	41.00	0.00

More images:

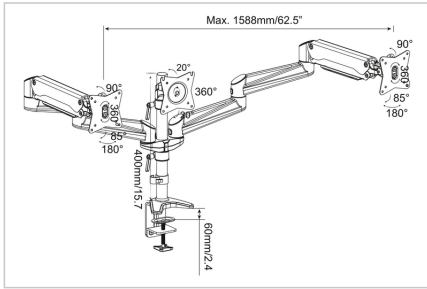
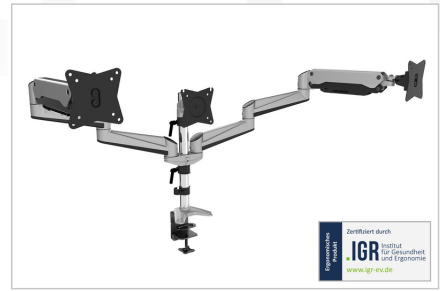
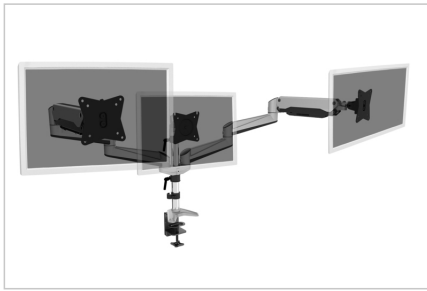

Safety notes

- Please read the entire manual before starting assembly and installation. Please contact your local dealer if you have any questions about the instructions or warnings.
- CAUTION: Use with products that exceed the permitted weight may result in damage or possible injury.
- Brackets should be fitted in accordance with the installation instructions. Incorrect installation can result in damage or injury.
- Use safety equipment and suitable tools. The product should only be installed by specialists.
- This product can be installed on timber-framed, solid concrete or stone walls.
- The load-bearing surfaces should be able to safely withstand the entire weight of appliances and all additional components.
- Only use the installation screws supplied and DO NOT TIGHTEN the screws TOO TIGHT.
- This product contains small parts that can cause a choking hazard if swallowed. Keep these parts away from children.
- Only use this product indoors. Using the product outdoors can lead to injury and damage.
- IMPORTANT: Before installation, please check all components received against the components list. If parts are damaged or missing, ask your local dealer for replacement parts.
- MAINTENANCE: Check the bracket regularly for safety and stability (preferably every three months).

EU responsible person

EU based economic operator ensuring the product complies with the required regulations.

ASSMANN Electronic GmbH
 Auf dem Schüffel 3
 Lüdenscheid, Germany
<https://www.assmann.com>
info@assmann.com