

DIGITUS® Triple monitor mount, 3x 27", 3x 6 kg

DA-90363

EAN 4016032425571



Triple Monitor Gas Spring Mount, 15-27", silver max load 6kg, max VESA 100x100

Universal table clamp mount enables the installation of LED and LCD monitors of all brands up to a size of 69 cm (27"). Thanks to the arm with gas pressure spring, you can fix your monitor at any height. Please only note the VESA dimensions and the weight of your monitor to select a suitable monitor mount.

Universal triple table mount with gas pressure spring for fully flexible monitor adjustment in 4 levels

- Integrated cable routing
- Suitable for VESA standard distances 75 x 75 and 100 x 100 mm
- Max. Load 6 kg per arm
- Weight: 7.4 kg

- Dimensions: 150 x 1588 x 410 mm
- Tested & certified ergonomic product - Certified by IGR (Institute for Health and Ergonomics)

Attributes

- Broj monitora: 3
- Način ugradnje: Ugradnja s držačem
- Težina monitora (maks.): 6 kg
- Veličine monitora: do 27"
- VESA nosač: 75x75 mm, 100x100 mm

Package contents

- Monitor stand
- Screws for monitor mounting
- Operating instructions

Logistics						
	Number (pcs)	Weight (kg)	Depth (cm)	Width (cm)	Height (cm)	cm ³
Packaging Unit Carton	2	18.40	59.50	48.50	31.50	90,901.10
Packaging Unit Inside	1	9.20	13.50	57.00	46.30	35,627.90
Packaging Unit Single	1	9.20	13.50	57.00	46.30	35,627.90
Net single without Packaging	1	7.40	11.80	158.80	41.00	0.00

More images:

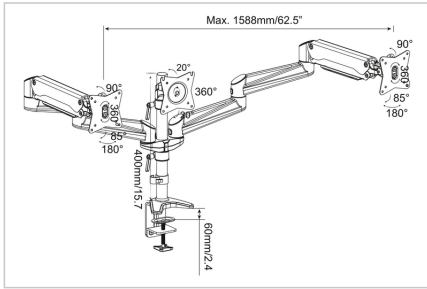
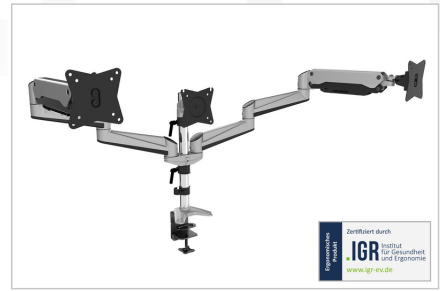
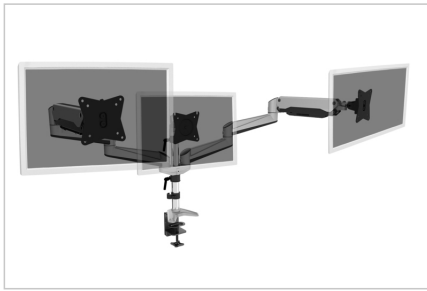

Safety notes

- Please read the entire manual before starting assembly and installation. Please contact your local dealer if you have any questions about the instructions or warnings.
- CAUTION: Use with products that exceed the permitted weight may result in damage or possible injury.
- Brackets should be fitted in accordance with the installation instructions. Incorrect installation can result in damage or injury.
- Use safety equipment and suitable tools. The product should only be installed by specialists.
- This product can be installed on timber-framed, solid concrete or stone walls.
- The load-bearing surfaces should be able to safely withstand the entire weight of appliances and all additional components.
- Only use the installation screws supplied and DO NOT TIGHTEN the screws TOO TIGHT.
- This product contains small parts that can cause a choking hazard if swallowed. Keep these parts away from children.
- Only use this product indoors. Using the product outdoors can lead to injury and damage.
- IMPORTANT: Before installation, please check all components received against the components list. If parts are damaged or missing, ask your local dealer for replacement parts.
- MAINTENANCE: Check the bracket regularly for safety and stability (preferably every three months).

EU responsible person

EU based economic operator ensuring the product complies with the required regulations.

ASSMANN Electronic GmbH
 Auf dem Schüffel 3
 Lüdenscheid, Germany
<https://www.assmann.com>
info@assmann.com