

DIGITUS®

DA-90354

EAN 4016032383161

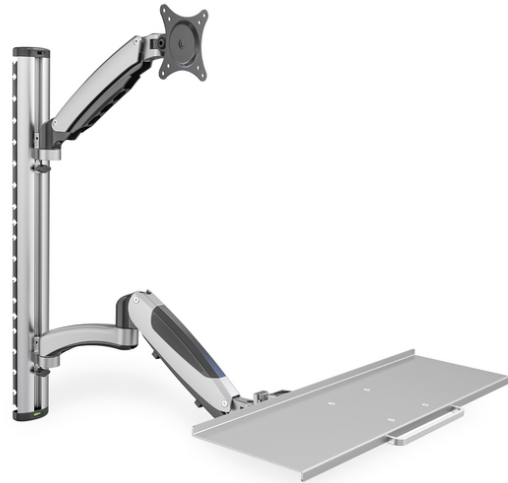

Monitor & Keyboard mount for LCD/LED max. load 8kg, VESA 100x100

Digitus DA-90354 is a professional monitor and keyboard mount designed for LCD/LED monitors. It features a sleek, modern design and is compatible with VESA 100x100 monitors. The mount is made of high-quality aluminum and is capable of supporting a maximum load of 8kg. It is designed to be mounted on a desk or wall, providing a flexible and adjustable viewing angle for the monitor. The keyboard tray is also adjustable, allowing for a more ergonomic workspace. The mount is easy to install and is a great addition to any office or home workstation.

- Professional design
- Maximum load 8kg
- VESA 100x100 compatible
- 6-year warranty
- 4.2 stars

- Dimensions: 700 x 700 x 520 mm

Package contents

- 1 x Digitus DA-90354 Monitor & Keyboard Mount
- 1 x VESA 100x100 Mounting Bracket
- 1 x Keyboard Tray
- 1 x User Manual

Logistics

	Number (pcs)	Weight (kg)	Depth (cm)	Width (cm)	Height (cm)	cm ³
Packaging Unit Carton	2	12.66	78.00	25.50	23.00	45,747.00
Packaging Unit Inside	1	6.33	76.50	23.00	10.00	17,595.00
Packaging Unit Single	1	6.33	76.50	23.00	10.00	17,595.00
Net single without Packaging	1	4.82	83.40	73.00	60.00	0.00

More images:

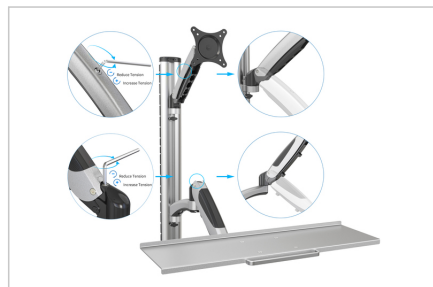
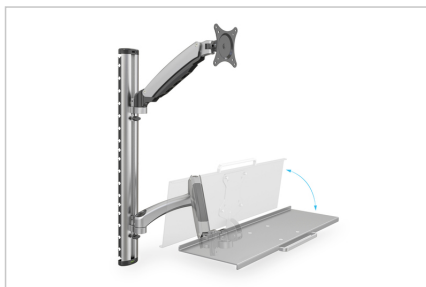

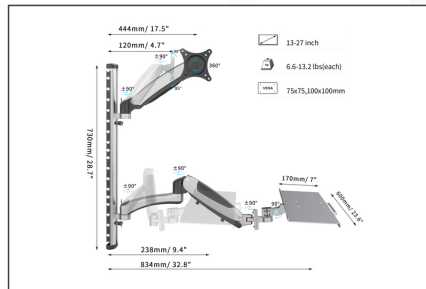
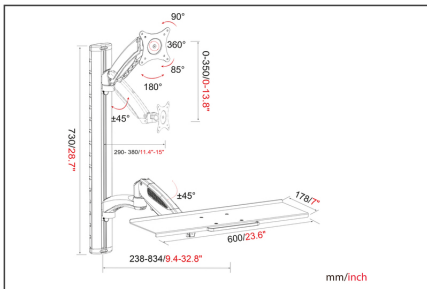

Safety notes

- Please read the entire manual before starting assembly and installation. Please contact your local dealer if you have any questions about the instructions or warnings.
- CAUTION: Use with products that exceed the permitted weight may result in damage or possible injury.
- Brackets should be fitted in accordance with the installation instructions. Incorrect installation can result in damage or injury.
- Use safety equipment and suitable tools. The product should only be installed by specialists.
- The load-bearing surfaces should be able to safely withstand the entire weight of appliances and all additional components.
- Only use the installation screws supplied and DO NOT TIGHTEN the screws TOO TIGHT.
- This product contains small parts that can cause a choking hazard if swallowed. Keep these parts away from children.
- Only use this product indoors. Using the product outdoors can lead to injuries and damage.
- IMPORTANT: Before installation, please check all components received against the components list. If parts are damaged or missing, ask your local dealer for replacement parts.

EU responsible person

EU based economic operator ensuring the product complies with the required regulations.

ASSMANN Electronic GmbH
 Auf dem Schüffel 3
 Lüdenscheid, Germany
<https://www.assmann.com>
info@assmann.com