

DIGITUS® DisplayPort Adapter

AK-340602-000-S
EAN 4016032289715



DisplayPort adapter, DP - HDMI type A M/F,w/interlock, CE, bl

With this adapter you can connect a HDMI cable to the DP interface of your graphic card or Notebook, for example.

Robust adapter, high mechanical load capacity

- Support up to 1080p with 60Hz
- Support DP++ Dual-Mode
- Supported transmission modes: RBR, HBR, HBR2
- Maximal bandwidth: 10,8 Gbps
- HBR-Version/transfer mode: HBR1 (2,70 Gbit/s per lane)
- HDCP-Version: HDCP 1.3

Attributes

- Assortment: DisplayPort Cables
- Color connector: black
- Connector 1: DP, plug
- Connector 2: HDMI type A, jack
- Connector surface: nickel-plated
- DisplayPort standard: DisplayPort 1.1a
- HDTV Standard: Full HD
- Hoods: molded
- Interlock: Snap fastener
- Resolution max.: 1920 x 1080 Pixel, 60Hz
- Length: 0.1 m
- AOC - Active Optical Cable: no

Logistics						
	Number (pcs)	Weight (kg)	Depth (cm)	Width (cm)	Height (cm)	cm³
Packaging Unit Carton	460	9.00	50.00	32.00	21.00	33,600.00
Packaging Unit Inside	20	0.39	21.00	15.00	3.00	945.00
Packaging Unit Single	1	0.02	20.00	9.00	2.00	360.00
Net single without Packaging	1	0.01	2.00	6.00	2.00	0.00

More images:

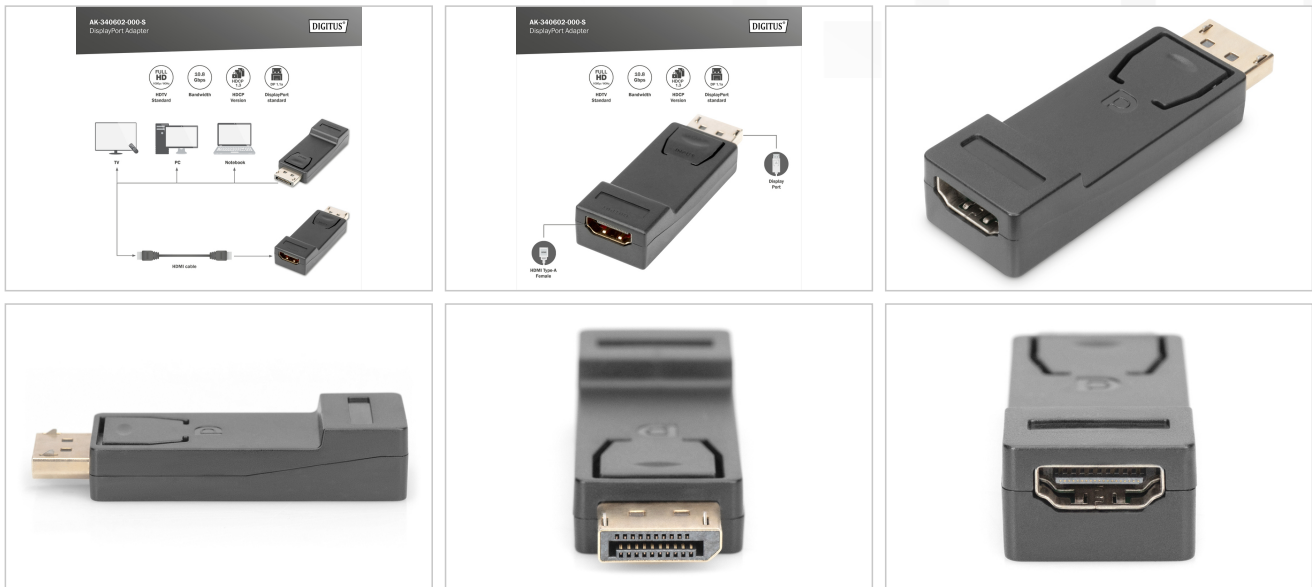

Safety notes

- When plugging and unplugging the cable, only grasp the plug and do not pull directly on the cable.
- Cables must not be kinked sharply or bent at tight angles, as this can damage the inner wires and lead to failures.
- Make sure that the cables are not under tensile load, as this can damage the insulation and the wires inside the cable.
- Ensure that cables are not laid in areas where they can be easily damaged mechanically.
- Cables should not be used in environments with extremely high or very low temperatures. Observe the product information on the maximum operating temperature of the cable
- Check cables regularly for visible damage such as cracks, kinks or signs of wear. Defective cables should be replaced immediately to avoid failures, short circuits or even electric shocks.

EU responsible person

EU based economic operator ensuring the product complies with the required regulations.

ASSMANN Electronic GmbH
 Auf dem Schüffel 3
 Lüdenscheid, Germany
<https://www.assmann.com>
info@assmann.com