

DIGITUS USB connection cable

AK-300102-030-E
EAN 4016032282631



USB connection cable, type A - B M/M, 3.0m, USB 2.0 suitable, beige

For connection of external USB devices (with B socket, e. g. external HDD enclosure, scanner or printer) to the USB Host (e. g. PC, Notebook or USB Hub). Datatransferrate up to 480 Mbps (High-Speed).

Allows a reliable and fast connection of external USB devices to the PC.

Attributes

- Assortment: USB Cables
- Color cable: beige
- Color connector: beige
- Connector 1: USB A, plug
- Connector 2: USB B, plug
- Connector surface: nickel-plated
- Hoods: molded
- USB compliance: USB 2.0
- Length: 3 m

Logistics

	Number (pcs)	Weight (kg)	Depth (cm)	Width (cm)	Height (cm)	cm ³
Packaging Unit Carton	230	14.80	32.00	45.00	25.00	36,000.00
Packaging Unit Inside	10	0.64	21.00	34.00	3.00	2,142.00
Packaging Unit Single	1	0.06	1.00	25.00	14.00	350.00
Net single without Packaging	1	0.07	1.00	14.00	10.00	0.00

More images:

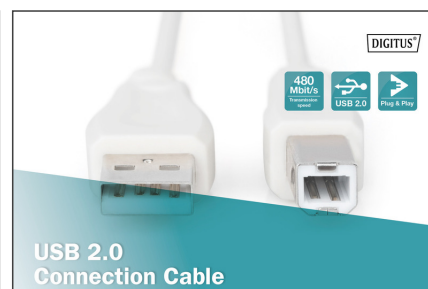
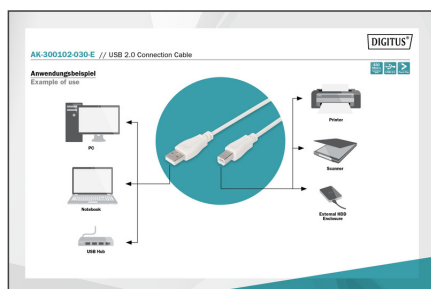

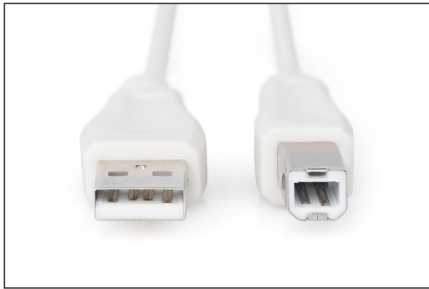
**Safety notes**

- When plugging and unplugging the cable, only grasp the plug and do not pull directly on the cable.
- Cables must not be kinked sharply or bent at tight angles, as this can damage the inner wires and lead to failures.
- Make sure that the cables are not under tensile load, as this can damage the insulation and the wires inside the cable.
- Ensure that cables are not laid in areas where they can be easily damaged mechanically.
- Cables should not be used in environments with extremely high or very low temperatures. Observe the product information on the maximum operating temperature of the cable
- Check cables regularly for visible damage such as cracks, kinks or signs of wear. Defective cables should be replaced immediately to avoid failures, short circuits or even electric shocks.

EU responsible person

EU based economic operator ensuring the product complies with the required regulations.

ASSMANN Electronic GmbH
Auf dem Schöffel 3
Lüdenscheid, Germany
<https://www.assmann.com>
info@assmann.com